

Fig. 212

Medium Pipe Clamp

Size Range: 1/2" through 30"

Material: Carbon steel

Finish: Plain or Galvanized

Service: Recommended for suspension of cold pipe lines or hot lines where no insulation is required.

Maximum Temperature: Plain 750° F, Galvanized 450° F

Approvals: Complies with Federal Specification A-A-1192A (Type 4) WW-H-171-E (Type 4), ANSI/MSS SP-69 and MSS SP-58 (Type 4). UL, ULC Listed and FM Approved (Sizes 3/4" - 8").

Installation: Normally used with weldless eye nut Fig. 290, page 83 or eye rod.

Features:

- Clamps tightly to pipe.
- Wide range of sizes.
- Equal gap design on many sizes.

Ordering: Specify pipe size, figure number, name and finish.

Note: The "C" gap dimension ensures adequate clearance at the top attachment point for a weldless eye nut or other appropriate rod attachment. This gap may or may not be present on the bottom portion of the clamp. If different loads or dimensions are required, refer to Fig. 42 SD non-standard two bolt pipe clamp.

Note: This picture is representative of a typical Figure 212. Distance between clamp ears beneath pipe may or may not be equal to upper gap.

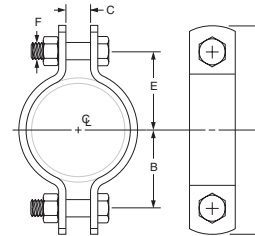

FIG. 212: LOADS (LBS) • WEIGHT (LBS) • DIMENSIONS (IN)

Pipe Size	Span Ft.	Max Load For Service Temp		Weight	B	C	Rod Take Out E	H	D	F	
		650° F	750° F								
1/2	7*	500	-	0.29	1	1/2	1 3/16	1 17/32	1 23/32	5/16	
3/4				0.33	1 1/8		1 1/4	1 21/32	1 25/32		
1				0.35	1 7/16		1 3/8	1 29/32	1 29/32		
1 1/4				0.38	1 9/16		1 5/8	1 31/32	2 3/32		
1 1/2	9*	800	930	0.43	1 11/16	5/8	1 11/16	2 3/32	2 7/32	1/2	
2	1.10			2 1/8	2 1/8		2 3/4	2 3/4			
2 1/2	1.20			2 5/8	2 5/8		3 1/4	3 1/4			
3	1.40			2 7/8	2 7/8		3 1/2	3 1/2			
3 1/2	13*	1,040	930	1.50	3 3/16	3/4	3 3/16	3 13/16	3 13/16	5/8	
4	1.80			3 1/2	3 1/2		4 1/4	4 1/4			
5	2.60			4 3/16	4 3/16		4 15/16	4 15/16			
6	5.40			4 7/8	4 7/8		5 3/4	5 3/4			
8	19*	1,615	1,440	6.50	6	1 1/4	6	6 7/8	6 7/8	3/4	
10	13.60			7 7/16	7 7/16		8 9/16	8 9/16			
12	15.20			8 7/16	8 7/16		9 9/16	9 9/16			
14	20.50			9 1/4	9 1/4		10 5/8	10 5/8			
16	15	2,490	2,220	22.30	10 1/4	1 1/8	10 1/4	11 5/8	11 5/8	7/8	
18	31.60			11 5/8	1 1/4		11 5/8	13	13		1
20	35.80			12 3/4	1 3/8		12 3/4	14 1/8	14 1/8		1 1/8
24	53.10			15 1/4	1 5/8		15 1/4	16 7/8	16 7/8		1 1/4
30	9	3,500	3,360	113.90	19	2	19	21 1/8	21 1/8	1 3/4	

Clamps may be furnished with square ends. "Span" represents the maximum recommended distance between hangers on a continuous & straight run of horizontal standard weight steel pipe filled with water. In all cases, verify that chosen location of hangers does not subject hangers to a load greater than the maximum recommended load shown above. For vapor service, the presence of fittings or insulation, and other weights and types of pipe, spans may either increase or decrease. In all cases, verify that chosen location of hanger does not subject hangers to a load greater than the maximum recommended load shown. *Indicates that span represents the maximum span for water filled pipe as given in Table 1 of page 201.

PROJECT INFORMATION		APPROVAL STAMP	
Project:		<input type="checkbox"/> Approved	
Address:		<input type="checkbox"/> Approved as noted	
Contractor:		<input type="checkbox"/> Not approved	
Engineer:		Remarks:	
Submittal Date:			
Notes 1:			
Notes 2:			