

## Hex Nuts

- Material: ASTM A536 Gr. A steel.  
ASTM F468 silicon bronze
- Finish: Yellow Zinc (YZ)

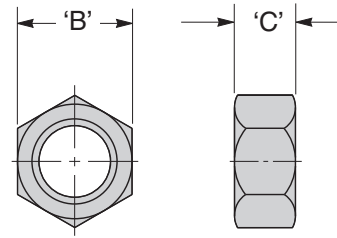

Part Number		Thread Size	'B'		'C'		Weight Per 100	
YZN	Silicon Bronze		In.	(mm)	In.	(mm)	Lbs.	(kg)
12-24HNYZ	12-24HNSB	#12-24	7/16"	(11.1)	5/32"	(3.9)	1.0	(0.45)
1/4HNYZ	1/4HNSB	1/4"-20	7/16"	(11.1)	7/32"	(5.5)	1.0	(0.45)
5/16HNYZ	5/16HNSB	5/16"-18	1/2"	(12.7)	17/64"	(6.7)	1.0	(0.45)
3/8HNYZ	3/8HNSB	3/8"-16	9/16"	(14.3)	21/64"	(8.3)	2.0	(0.91)
1/2HNYZ	1/2HNSB	1/2"-13	3/4"	(19.0)	7/16"	(11.1)	6.0	(2.72)
5/8HNYZ	5/8HNSB	5/8"-11	15/16"	(23.8)	35/64"	(13.9)	7.0	(3.17)

## Flat Washer

- Material: ASTM 844 steel.  
651 alloy silicon bronze
- Finish: Steel - Yellow Zinc (YZ)

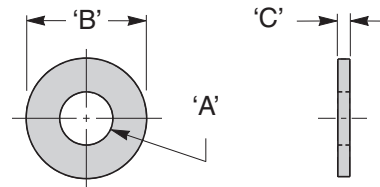

Part Number		Thread Size	'A'		'B'		'C'		Weight Per 100	
YZN	Silicon Bronze		In.	(mm)	In.	(mm)	In.	(mm)	Lbs.	(kg)
12-24FWYZ	--	#12-24	1/4"	(6.3)	9/16"	(14.3)	3/64"	(1.19)	0.30	(0.13)
1/4FWYZ	1/4FWSB	1/4"-20	5/16"	(7.9)	3/4"	(19.0)	1/16"	(1.59)	0.40	(0.18)
5/16FWYZ	5/16FWSB	5/16"-18	3/8"	(9.5)	3/4"	(19.0)	5/64"	(1.98)	1.20	(0.54)
3/8FWYZ	3/8FWSB	3/8"-16	7/16"	(11.1)	1"	(25.4)	5/64"	(1.98)	1.60	(0.72)
1/2FWYZ	1/2FWSB	1/2"-13	9/16"	(14.3)	1 3/8"	(34.9)	7/64"	(2.78)	4.10	(1.86)
5/8FWYZ	--	5/8"-11	1 1/16"	(17.4)	1 3/4"	(44.4)	9/64"	(3.57)	7.30	(3.31)

## Lock Washer

- Material: ANSI 18.21.1 steel.  
651 alloy silicon bronze
- Finish: Steel - Yellow Zinc (YZ)

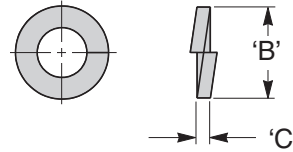

YZN	Part Number Silicon Bronze	Thread Size	'B'		'C'		Weight Per 100	
			In.	(mm)	In.	(mm)	Lbs.	(kg)
--	<b>10-24LWSB</b>	#10-24	2 <sup>1</sup> / <sub>64</sub> "	(8.2)	.05"	(1.3)	0.1	(0.04)
<b>1/4LWYZ</b>	<b>1/4LWSB</b>	1/4"-20	1 <sup>5</sup> / <sub>32</sub> "	(11.9)	.05"	(1.3)	3.0	(1.36)
<b>5/16LWYZ</b>	<b>5/16LWSB</b>	5/16"-18	1 <sup>9</sup> / <sub>32</sub> "	(15.1)	.09"	(2.3)	4.0	(1.81)
<b>3/8LWYZ</b>	<b>3/8LWSB</b>	3/8"-16	1 <sup>1</sup> / <sub>16</sub> "	(17.4)	.10"	(2.5)	6.0	(2.72)
<b>1/2LWYZ</b>	<b>1/2LWSB</b>	1/2"-13	7/8"	(22.2)	.13"	(3.3)	13.0	(5.89)
<b>5/8LWYZ</b>	--	5/8"-11	1 <sup>3</sup> / <sub>32</sub> "	(27.8)	.17"	(4.3)	25.0	(11.34)

## Two Hole Plate

- Material: ASTM A36 structural steel
- Finish: Yellow Zinc (YZ)

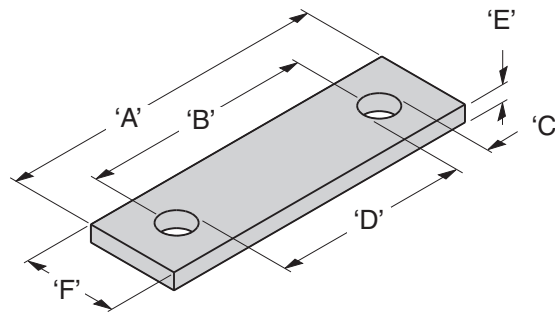

Part Number	'A'		'B'		'C'		'D'		'E'		'L'		Weight	
	In.	(mm)	In.	(mm)	In.	(mm)	In.	(mm)	In.	(mm)	In.	(mm)	Lbs.	(kg)
<b>SB21501</b>	3 <sup>5</sup> / <sub>8</sub> "	(92)	2 <sup>7</sup> / <sub>16</sub> "	(62)	7/16"	(11)	2"	(51)	3/16"	(5)	1 <sup>1</sup> / <sub>4</sub> "	(32)	0.25	(0.11)
<b>SB21502</b>	3 <sup>13</sup> / <sub>16</sub> "	(97)	2 <sup>5</sup> / <sub>8</sub> "	(66)	9/16"	(14)	2 <sup>1</sup> / <sub>16</sub> "	(52)	3/16"	(5)	1 <sup>1</sup> / <sub>4</sub> "	(32)	0.25	(0.11)
<b>SB21503</b>	3 <sup>1</sup> / <sub>4</sub> "	(82)	2 <sup>1</sup> / <sub>16</sub> "	(52)	9/16"	(14)	1 <sup>1</sup> / <sub>2</sub> "	(38)	3/16"	(5)	1 <sup>1</sup> / <sub>4</sub> "	(32)	0.20	(0.09)
<b>SB21504</b>	3 <sup>3</sup> / <sub>4</sub> "	(95)	2 <sup>9</sup> / <sub>16</sub> "	(65)	3/8"	(9)	2 <sup>3</sup> / <sub>16</sub> "	(55)	3/16"	(5)	1 <sup>1</sup> / <sub>4</sub> "	(32)	0.20	(0.09)
<b>SB21505</b>	3 <sup>1</sup> / <sub>2</sub> "	(89)	2 <sup>7</sup> / <sub>16</sub> "	(62)	3/8"	(9)	2 <sup>1</sup> / <sub>16</sub> "	(52)	3/16"	(5)	1 <sup>1</sup> / <sub>4</sub> "	(32)	0.20	(0.09)
<b>SB21506</b>	5 <sup>1</sup> / <sub>8</sub> "	(130)	4 <sup>3</sup> / <sub>8</sub> "	(111)	3/8"	(9)	4"	(101)	1/4"	(6)	1 <sup>1</sup> / <sub>4</sub> "	(32)	0.35	(0.16)
<b>SB21507</b>	6 <sup>3</sup> / <sub>4</sub> "	(171)	5 <sup>3</sup> / <sub>4</sub> "	(146)	9/16"	(14)	5 <sup>3</sup> / <sub>16</sub> "	(132)	3/8"	(9)	2"	(51)	1.40	(0.63)

## Touch-Up Paint

- Lacquer - Semi Gloss 13 oz. spray
- Fast drying
- High solids for coverage

Part Number	Color	Weight	
		Lbs.	(kg)
<b>SB420A</b>	Gray	0.9	(0.41)
<b>SB420B</b>	Black	0.9	(0.41)

