

***Duriron
Split
Flanged
Pipe and
Fittings***

***Price
Sheet***

**EFFECTIVE DATE
September 2009**

Duriron Split Flanged Pipe and Fittings



Fig. 1

In addition to Bell and Spigot and Mechanical Joint type piping, Duriron corrosion resistant process piping is available in a split flange design. Duriron split flange pipe and fittings are available in 1" through 8" sizes. Larger sizes through 16" and nonstandard lengths of pipe may be obtained by special order. Pipe and fittings also may be made from Durichlor 51, a modification of Duriron that contains 4% chromium nominally, by special order. Complete dimensions for Duriron split flange pipe and fittings are contained on the following pages.

Connections on pipe and fittings are made by means of a split flange consisting of two interlocking halves as shown in Figure 1. One complete two-piece flange is furnished for each beaded end; thus two complete flanges are supplied with each length of pipe, three with each tee, etc.

Flanges are normally furnished in malleable iron with American Standard Class 125 Drilling, which has the same dimensions as ANSI Class 150. These flanges are flexible enough to adapt to the contour of the beaded ends and strong enough to make an absolutely tight joint without damage to the pipe or fittings. However, for additional strength, cast steel split flanges are available also. Additionally, where the exterior of the pipe may be exposed to a corrosive atmosphere, split flanges can be supplied in Alloy 20, a stainless steel possessing corrosion resistance superior to 316 stainless steel.

Duriron High Silicon Iron

Duriron is a high silicon iron alloy that is corrosion resistant to practically all commonly used process chemicals. In fact, the alloy's resistance to such a wide variety of corrosive chemicals has been claimed by many to be unmatched by any other commercially available metal or alloy.

Duriron obtains its outstanding corrosion resistance from the 14.5% silicon present in its composition. Durichlor 51 is a modification of Duriron that contains chromium to increase its resistance to oxidizing chemicals such as hypochlorite bleaches, chlorine dioxide, and chloride containing services. To learn more about the corrosion resistance of Duriron and Durichlor 51 to specific chemicals refer to Bulletins A/2 and A/5.

Duriron and Durichlor 51 are extremely hard and are resistant to abrasion and erosion as well as corrosion. They have dense, homogenous compositions throughout the wall thickness. Duriron and Durichlor 51 are not coatings or linings.

While the strength of high silicon iron piping is considerably greater than that of almost all non-metallic piping, the tensile strength of this material is less than most metals, including normal cast iron. Consequently, caution should be exercised during handling not to subject the pipe to undue mechanical stress or thermal shock.

Installation of Duriron Split Flange Piping

Duriron split flange piping is designed for fast and easy installation. Before tightening the bolts on the split flanges, the ground faces of the pipe or fittings must be accurately aligned and an acid resistant gasket inserted to separate the faces. Flowserve recommends using Gylon 3545 PTFE gaskets made by Garlock Sealing Technologies. The bolts should be drawn up evenly. It is important to maintain an even balance of tension until the joint is secure. High silicon iron piping cannot be bent or drifted into line.

Duriron and Durichlor 51 pipe can be furnished to exact lengths. Installations should be made on the basis of such measurements to prevent distortion. Plain end shims from 1/4 inch to 3 inches wide can be supplied to make up small gaps. Faced on both ends, these shims are held in compression between the split flange beads using longer through bolts.

Hanging and Expansion Joints

Flowserve recommends supporting horizontal lines of pipe with hangers at each joint. Vertical lines of pipe should be supported at 10 foot intervals.

Where long horizontal or vertical lines are installed, expansion joints should be inserted every 50 feet. Expansion joints are recommended at shorter intervals if large temperature fluctuations are expected. High silicon iron expansion joints are shown on page 11 of this bulletin. PTFE expansion joints also are available in 1-4 inch sizes.

Underground Installations

Lines run underground should be laid in a box trench to allow for proper expansion and contraction of the piping.

Special Connections

Split flange pipe can be connected to lead or screwed pipe with companion flanges. Ordinary cast iron flanges are adequate, but stainless steel flanges can be supplied.

Hose connections can be made using fittings shown on pages 10 and 11 of this bulletin. Hose connections adapt rigid pipe or equipment to a flexible line. These fittings may be used to couple lengths of hose or to attach hose to flanged equipment. Hose connections also may be made with the draw-off elbows shown on page 5 of this bulletin. The spigot end of the draw-off elbow has a reinforcing bead that can be inserted into the hose to make what is essentially an elbow hose connection.

Hose connections are frequently used on portable pumping units where lines need to be relocated frequently. Another important use of a hose connection is to eliminate the transmission of vibration between two or more flanged pieces of equipment.

When selecting hose connections, however, the restriction of flow must be considered. The inner diameters of the hose connections are smaller than the inner diameters of the hose to which they will connect. For example, the I.D. of a hose connection for 1/2 inch diameter hose is actually 1/4 inch.

Pressure and Temperature Capabilities

Pipe pressure ratings for Duriron and Durichlor 51 cannot be stated in the customary manner used by manufacturers of steel pipe because of such variables as thermal shock, pulsating pressures, and corrosive media. Nonetheless, all sizes of pipe are periodically tested to destruction by water at ambient temperature. For services subject to pressure greater than 50 psi Flowserve Corporation should be consulted.

While extreme, sudden fluctuations in temperature should be avoided to prevent thermal shock, Duriron is suitable for use at unusually high temperatures. In fact, Duriron equipment is used successfully at temperatures as high as 1400°F. However, in such cases, Duriron should be brought up (or down) to temperature gradually. For operating temperatures above 450°F, Flowserve Corporation should be consulted regarding gasket material.

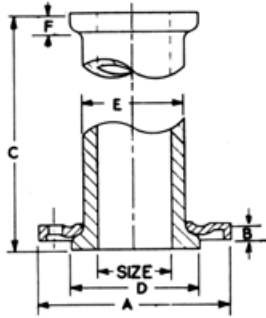
Split Flanged Pipe

Size in (mm)	Part Number	A in (mm)	B in (mm)	C in (mm)	D in (mm)	E in (mm)	F in (mm)	Bolt Circle in (mm)	Weight lbs (kg)	Price
1 (25)	PH3650A	4 ¹ / ₄ (108)	1/2 (13)	36 (914)	2 ¹ / ₁₆ (52)	1 ³ / ₄ (44)	9/16 (14)	3 ¹ / ₈ (79)	15 (6.8)	\$1634
1 ¹ / ₂ (40)	CY5163A	5 (127)	9/16 (14)	36 (914)	2 ¹⁵ / ₁₆ (75)	2 ¹ / ₄ (57)	9/16 (14)	3 ⁷ / ₈ (98)	18 (8.2)	1670
2 (50)	DY5393A	6 (152)	9/16 (14)	48 (1219)	3 ⁹ / ₁₆ (90)	2 ³ / ₄ (70)	5/8 (16)	4 ³ / ₄ (121)	32 (14.5)	1842
2 ¹ / ₂ (65)	DY11695A	7 (178)	1 ¹ / ₁₆ (17)	60 (1524)	4 ⁵ / ₁₆ (110)	3 ¹ / ₄ (83)	5/8 (16)	5 ¹ / ₂ (140)	45 (20.4)	1866
3 (80)	DY11696A	7 ¹ / ₁₆ (191)	1 ¹ / ₁₆ (17)	60 (1524)	4 ¹³ / ₁₆ (122)	3 ⁷ / ₈ (98)	3/4 (19)	6 (152)	62 ¹ / ₂ (28.4)	1886
4 (100)	DY11697A	9 (229)	3/4 (19)	60 (1524)	6 ¹ / ₁₆ (154)	4 ⁷ / ₈ (124)	7/8 (22)	7 ¹ / ₂ (191)	100 (45.4)	2770
6 (150)	DY5245A	11 (279)	1 ³ / ₁₆ (21)	60 (1524)	8 ¹ / ₁₆ (205)	7 (179)	7/8 (22)	9 ¹ / ₂ (241)	180 (81.6)	3914
8 (200)	PH3650D	13 ¹ / ₂ (343)	7/8 (22)	60 (1524)	10 ⁵ / ₁₆ (262)	9 ¹ / ₄ (235)	1 (25)	11 ³ / ₄ (298)	265 (120.2)	4400
10 (250)	PH3650E	16 (406)	1 ⁵ / ₁₆ (24)	60 (1524)	12 ¹¹ / ₁₆ (322)	11 ¹ / ₂ (292)	1 ¹ / ₈ (29)	14 ¹ / ₄ (362)	433 (196.4)	7810
12 (300)	PH3650F	19 (483)	1 (25)	60 (1524)	15 ⁵ / ₁₆ (389)	14 (356)	1 ¹ / ₄ (32)	17 (432)	694 (314.8)	11344

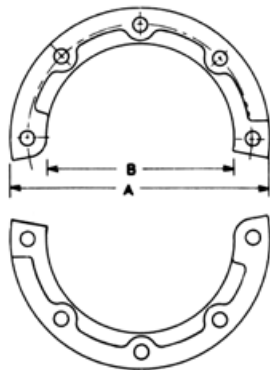
Split Flanges

Pipe Size in (mm)	Part Number	A in (mm)	B in (mm)	Dia. of Bolt Circle in (mm)	Dia. of Bolt Holes in (mm)	No. of Bolt Holes	Size of Bolt Holes in (mm)	Length of Bolts in (mm)	Price
1 (25)	KM-120	4 ¹ / ₄ (108)	1 ⁷ / ₈ (48)	3 ¹ / ₈ (79)	5/8 (16)	4	1/2 (13)	2 ¹ / ₂ (64)	\$ 13
1 ¹ / ₂ (40)	KM-121	5 (127)	2 ¹ / ₂ (64)	3 ⁷ / ₈ (98)	9/16 (14)	4	1/2 (13)	3 (76)	14
2 (50)	KM-122	6 (152)	3 ¹ / ₈ (79)	4 ³ / ₄ (121)	3/4 (19)	4	5/8 (16)	3 (76)	16
2 ¹ / ₂ (64)	KM-123	7 (179)	3 ⁵ / ₈ (92)	5 ¹ / ₂ (140)	3/4 (19)	4	5/8 (16)	3 (76)	26
3 (80)	KM-124	7 ¹ / ₂ (191)	4 ¹ / ₄ (108)	6 (152)	3/4 (19)	4	5/8 (16)	3 ¹ / ₂ (89)	28
4 (100)	KM-125	9 (229)	5 ¹ / ₄ (133)	7 ¹ / ₂ (191)	3/4 (19)	8	5/8 (16)	4 (101)	32
6 (150)	KM-126	11 (279)	7 ¹ / ₂ (191)	9 ¹ / ₂ (241)	7/8 (22)	8	3/4 (19)	4 (101)	44
8 (200)	KM-127	13 ¹ / ₂ (343)	9 ⁵ / ₈ (244)	11 ³ / ₄ (298)	7/8 (22)	8	3/4 (19)	4 ¹ / ₂ (114)	74
10 (250)	KM-128	16 (406)	12 (305)	14 ¹ / ₄ (362)	1 (25)	12	7/8 (22)	5 (127)	82
12 (300)	KM-129	19 (483)	14 ⁵ / ₈ (371)	17 (432)	1 (25)	12	7/8 (22)	5 (127)	108

Split flange bolt circle, bolt hole size and number of bolt holes are to American Standard Class 125, which is dimensionally equivalent to ANSI Class 150.

Sold as Halves – one complete flange consists of two halves.

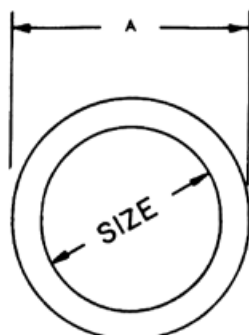
Gylon Gaskets

Size in (mm)	Part Number	A in (mm)	Thickness in (mm)	Price
1 (25)	Y24847A1	2 ⁵ / ₈ (67)	1/16 (2)	\$ 6
1 ¹ / ₂ (40)	Y24847A1-1/2	3 ¹ / ₄ (83)	1/16 (2)	6
2 (50)	Y24847A2	4 ¹ / ₈ (105)	1/16 (2)	8
2 ¹ / ₂ (64)	Y24847A2-1/2	4 ⁷ / ₈ (124)	1/16 (2)	11
3 (80)	Y24847A3	5 ³ / ₈ (136)	1/16 (2)	13
4 (100)	Y24847A4	6 ⁷ / ₈ (175)	1/16 (2)	17
6 (152)	Y24847A6	8 ³ / ₄ (222)	1/16 (2)	25
8 (203)	Y24847A8	11 (279)	1/16 (2)	36
10 (254)	Y24847A10	13 ³ / ₈ (340)	1/16 (2)	53
12 (305)	Y24847A12	16 ¹ / ₈ (410)	1/16 (2)	61

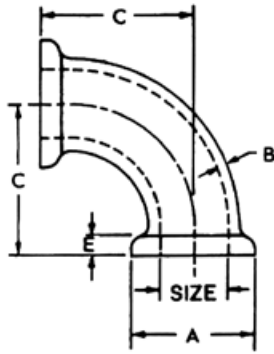
90 Degree Elbows

Size in (mm)	Part Number	Weight lbs (kg)	A in (mm)	B in (mm)	C in (mm)	E in (mm)	Price
1 (25)	CY17339A	4½ (2.0)	2 ¹ / ₁₆ (52)	³ / ₈ (10)	3½ (89)	⁷ / ₁₆ (11)	\$ 644
1½ (40)	CY17339C	8 (3.6)	2 ¹⁵ / ₁₆ (75)	³ / ₈ (10)	4 (101)	⁹ / ₁₆ (14)	656
2 (50)	CY17339D	10½ (4.8)	3 ⁹ / ₁₆ (90)	³ / ₈ (10)	4½ (114)	⁵ / ₈ (16)	670
2½ (65)	CY17339E	14½ (6.6)	4 ⁵ / ₁₆ (110)	³ / ₈ (10)	5 (127)	⁵ / ₈ (16)	926
3 (80)	CY17339F	24 (10.9)	4 ¹³ / ₁₆ (122)	⁷ / ₁₆ (11)	5½ (140)	³ / ₄ (19)	934
4 (100)	CY17339G	32 (14.5)	6 ¹ / ₁₆ (154)	⁷ / ₁₆ (11)	6½ (165)	⁷ / ₈ (22)	972
6 (150)	CY17339J	50 (22.7)	8 ¹ / ₁₆ (205)	¹ / ₂ (13)	8 (203)	⁷ / ₈ (22)	1232
8 (200)	CY17339K	88 (39.9)	10 ⁵ / ₁₆ (262)	⁵ / ₈ (16)	9 (229)	1 (25)	1966
10 (250)	CY17339L	122 (55.3)	12 ¹ / ₁₆ (322)	³ / ₄ (19)	11 (279)	¹ / ₈ (29)	5310
12 (300)	CY17339M	160 (72.6)	15 ⁵ / ₁₆ (389)	⁷ / ₈ (22)	12 (305)	¹ / ₄ (32)	5944

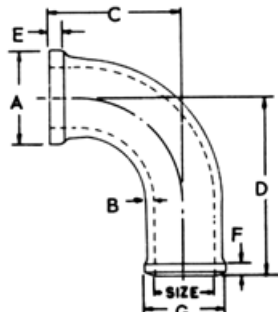
Draw-Off Elbows

Size in (mm)	Part Number	Weight lbs (kg)	A in (mm)	B in (mm)	C in (mm)	D in (mm)	E in (mm)	F in (mm)	G in (mm)	Price
1 (25)	PH3790A	5 (2.3)	2 ¹ / ₁₆ (52)	¹ / ₄ (6)	3½ (89)	4 (101)	¹⁵ / ₃₂ (12)	³ / ₈ (10)	1 ⁵ / ₈ (41)	\$ 610
1½ (40)	PH3790B	6 (2.7)	2 ¹⁵ / ₁₆ (75)	¹ / ₄ (6)	4 (101)	5 (127)	⁹ / ₁₆ (14)	³ / ₈ (10)	2 ¹ / ₈ (54)	622
2 (50)	PH3790C	6 (2.7)	3 ⁹ / ₁₆ (90)	¹ / ₄ (6)	4½ (114)	6 (152)	⁵ / ₈ (16)	³ / ₈ (10)	2 ⁵ / ₈ (67)	632
2½ (65)	PH3790D	10 (4.5)	4 ⁵ / ₁₆ (110)	¹ / ₄ (6)	5 (127)	7 (179)	⁵ / ₈ (16)	³ / ₈ (10)	3 ¹ / ₈ (79)	728
3 (80)	PH3790E	13 (5.9)	4 ¹³ / ₁₆ (122)	¹ / ₄ (6)	5½ (140)	8 (203)	³ / ₄ (19)	³ / ₈ (10)	3 ⁵ / ₈ (92)	876
4 (100)	PH3790F	20 (9.1)	6 ¹ / ₁₆ (154)	¹ / ₄ (6)	6½ (165)	9 (229)	³ / ₄ (19)	³ / ₈ (10)	4 ⁵ / ₈ (117)	1334

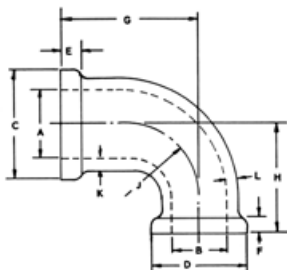
90 Degree Reducing Elbows

Part Number	Weight lbs (kg)	A in (mm)	B in (mm)	C in (mm)	D in (mm)	E in (mm)	F in (mm)	G in (mm)	H in (mm)	J in (mm)	K in (mm)	L in (mm)	Price
PH3656A	5 (2.3)	1½ (38)	1 (25)	2 ¹⁵ / ₁₆ (75)	2 ¹ / ₁₆ (52)	⁹ / ₁₆ (14)	⁹ / ₁₆ (14)	4 (101)	4 (101)	2 ³ / ₄ (70)	³ / ₈ (10)	³ / ₈ (10)	\$1082
PH3656B	5 (2.3)	2 (51)	1 (25)	3 ⁹ / ₁₆ (90)	2 ¹ / ₁₆ (52)	⁵ / ₈ (16)	⁹ / ₁₆ (14)	4½ (114)	4½ (114)	3½ (89)	³ / ₈ (10)	³ / ₈ (10)	1092
PH3656C	5½ (2.5)	2 (51)	1½ (38)	3 ⁹ / ₁₆ (90)	2 ¹⁵ / ₁₆ (75)	⁵ / ₈ (16)	⁹ / ₁₆ (14)	4½ (114)	4½ (114)	3 (76)	³ / ₈ (10)	³ / ₈ (10)	1096
PH3656D	10½ (4.8)	3 (76)	1½ (38)	4 ¹³ / ₁₆ (122)	2 ¹⁵ / ₁₆ (75)	³ / ₄ (19)	⁹ / ₁₆ (14)	5½ (140)	5½ (140)	3 ³ / ₄ (95)	⁷ / ₁₆ (11)	³ / ₈ (10)	1750
PH3656E	11 (5.0)	3 (76)	2 (51)	4 ¹³ / ₁₆ (122)	3 ⁹ / ₁₆ (90)	³ / ₄ (19)	⁵ / ₈ (16)	5½ (140)	5½ (140)	3 ³ / ₄ (95)	⁷ / ₁₆ (11)	³ / ₈ (10)	1760
PH3656F	14 (6.4)	4 (101)	1½ (38)	6 ¹ / ₁₆ (154)	2 ¹⁵ / ₁₆ (75)	⁷ / ₈ (22)	⁹ / ₁₆ (14)	6½ (165)	6½ (165)	4 ³ / ₄ (121)	⁷ / ₁₆ (11)	³ / ₈ (10)	1800
PH3656G	23 (10.4)	4 (101)	3 (76)	6 ¹ / ₁₆ (154)	4 ¹³ / ₁₆ (122)	⁷ / ₈ (22)	³ / ₄ (19)	6½ (165)	6½ (165)	6 (152)	⁷ / ₁₆ (11)	³ / ₈ (10)	1894
PH3656J	27 (12.2)	6 (152)	2 (51)	8 ¹ / ₁₆ (205)	3 ⁹ / ₁₆ (90)	⁷ / ₈ (22)	⁹ / ₁₆ (14)	8 (203)	8 (203)	6 (152)	¹ / ₂ (13)	³ / ₈ (10)	1900
PH3656K	30 (13.6)	6 (152)	2½ (64)	8 ¹ / ₁₆ (205)	4 ⁵ / ₁₆ (110)	⁷ / ₈ (22)	⁵ / ₈ (16)	8 (203)	8 (203)	6 (152)	¹ / ₂ (13)	³ / ₈ (10)	1916
PH3656N	32½ (14.7)	6 (152)	3 (76)	8 ¹ / ₁₆ (205)	4 ¹³ / ₁₆ (122)	⁷ / ₈ (22)	³ / ₄ (19)	8 (203)	8 (203)	4½ (114)	¹ / ₂ (13)	³ / ₈ (10)	1930
PH3656M	38 (17.2)	6 (152)	4 (101)	8 ¹ / ₁₆ (205)	6 ¹ / ₁₆ (154)	⁷ / ₈ (22)	⁷ / ₈ (22)	8 (203)	8 (203)	6 (152)	¹ / ₂ (13)	³ / ₈ (10)	1946
PH3656P	67 (30.4)	8 (203)	4 (101)	10 ⁵ / ₁₆ (262)	6 ¹ / ₁₆ (154)	1 (25)	⁷ / ₈ (22)	9 (229)	9 (229)	7 (179)	⁹ / ₁₆ (14)	⁷ / ₁₆ (11)	2158
PH3656Q	54 (24.5)	8 (203)	6 (152)	10 ⁵ / ₁₆ (262)	8 ¹ / ₁₆ (205)	1 (25)	⁷ / ₈ (22)	9 (229)	9 (229)	7 (179)	⁹ / ₁₆ (14)	⁷ / ₁₆ (11)	3198

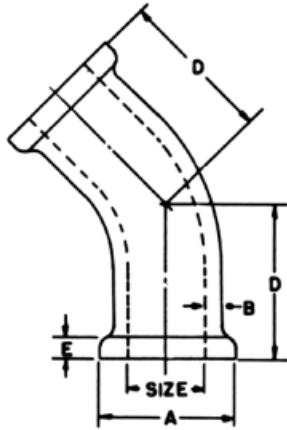
45 Degree Elbows

Size in (mm)	Part Number	Weight lbs (kg)	A in (mm)	B in (mm)	D in (mm)	E in (mm)	Price
1 (25)	CY17339N	4½ (2.0)	2 ¹ / ₁₆ (52)	³ / ₈ (10)	1¾ (44)	⁷ / ₁₆ (11)	\$ 712
1½ (40)	CY17339P	8 (3.6)	2 ¹⁵ / ₁₆ (75)	³ / ₈ (10)	2¼ (57)	⁹ / ₁₆ (14)	720
2 (50)	CY17339R	10½ (4.8)	3 ⁹ / ₁₆ (90)	³ / ₈ (10)	2½ (64)	⁵ / ₈ (16)	728
2½ (65)	CY17339S	14½ (6.6)	4 ⁵ / ₁₆ (110)	³ / ₈ (10)	3 (76)	⁵ / ₈ (16)	744
3 (80)	CY17339T	24 (10.9)	4 ¹³ / ₁₆ (122)	⁷ / ₁₆ (11)	3 (76)	³ / ₄ (19)	760
4 (100)	CY17339U	32 (14.5)	6 ¹ / ₁₆ (154)	⁷ / ₁₆ (11)	4 (101)	⁷ / ₈ (22)	806
6 (150)	CY17339V	50 (22.7)	8 ¹ / ₁₆ (205)	¹ / ₂ (13)	5 (127)	⁷ / ₈ (22)	1144
8 (200)	CY17339W	72 (32.7)	10 ⁵ / ₁₆ (262)	⁵ / ₈ (16)	5½ (140)	1 (25)	1844
10 (250)	CY17339X	87 (39.5)	12 ¹¹ / ₁₆ (322)	³ / ₄ (19)	6½ (165)	1½ (29)	5846

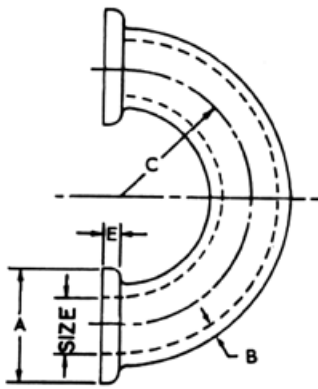
Return Bends

Size in (mm)	Part Number	Weight lbs (kg)	A in (mm)	B in (mm)	C in (mm)	E in (mm)	Price
1 (25)	CY17339AV	7 (3.2)	2 ¹ / ₁₆ (52)	³ / ₈ (10)	3½ (89)	⁷ / ₁₆ (11)	\$ 758
1½ (40)	CY17339AW	11 (5.0)	2 ¹⁵ / ₁₆ (75)	³ / ₈ (10)	4 (101)	⁹ / ₁₆ (14)	812
2 (50)	CY17339AX	16 (7.3)	3 ⁹ / ₁₆ (90)	³ / ₈ (10)	4½ (114)	⁵ / ₈ (16)	912
2½ (65)	CY17339AY	23 (10.4)	4 ⁵ / ₁₆ (110)	³ / ₈ (10)	5 (127)	⁵ / ₈ (16)	942
3 (80)	CY17339AZ	30 (13.6)	4 ¹³ / ₁₆ (122)	⁷ / ₁₆ (11)	5½ (140)	³ / ₄ (19)	996
4 (100)	CY17339BC	48 (21.8)	6 ¹ / ₁₆ (154)	⁷ / ₁₆ (11)	6½ (165)	⁷ / ₈ (22)	1092
6 (150)	CY17339BE	86 (39.0)	8 ¹ / ₁₆ (205)	¹ / ₂ (13)	8 (203)	⁷ / ₈ (22)	2000
8 (200)	CY17339BF	190 (86.2)	10 ⁵ / ₁₆ (262)	⁵ / ₈ (16)	9 (229)	1 (25)	4074

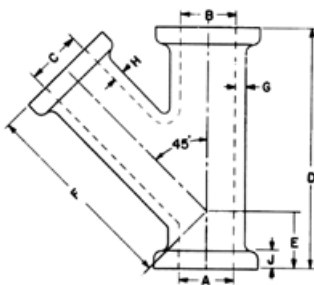
Laterals

Part Number	Weight lbs (kg)	A in (mm)	B in (mm)	C in (mm)	D in (mm)	E in (mm)	F in (mm)	G in (mm)	H in (mm)	J in (mm)	Price
D1861B	10 (4.5)	1½ (38)	1½ (38)	1½ (38)	9 (229)	2 (51)	7 (179)	³ / ₈ (10)	³ / ₈ (10)	⁹ / ₁₆ (14)	\$ 934
P3901B	12 (5.6)	2 (51)	2 (51)	2 (51)	10½ (267)	2½ (64)	8 (203)	³ / ₈ (10)	³ / ₈ (10)	⁵ / ₈ (16)	1824
D7560	22 (10.0)	3 (76)	2 (51)	2 (51)	19 (483)	3 (76)	10 (254)	⁷ / ₁₆ (11)	³ / ₈ (10)	³ / ₄ (19)	1856
P3901E	25 (11.3)	3 (76)	3 (76)	3 (76)	13 (330)	3 (76)	10 (254)	⁷ / ₁₆ (11)	⁷ / ₁₆ (11)	³ / ₄ (19)	1782
D5685-2	36 (16.3)	4 (101)	4 (101)	2 (51)	15 (381)	3 (76)	12 (305)	⁷ / ₁₆ (11)	³ / ₈ (10)	⁷ / ₈ (22)	1840
D5685-3	37 (16.8)	4 (101)	4 (101)	3 (76)	15 (381)	3 (76)	12 (305)	⁷ / ₁₆ (11)	⁷ / ₁₆ (11)	⁷ / ₈ (22)	1848
P3901H	40 (18.1)	4 (101)	4 (101)	4 (101)	15 (381)	3 (76)	12 (305)	⁷ / ₁₆ (11)	⁷ / ₁₆ (11)	⁷ / ₈ (22)	1904
P3901K	74 (33.6)	6 (152)	6 (152)	6 (152)	18 (457)	3½ (89)	14½ (368)	¹ / ₂ (13)	¹ / ₂ (13)	⁷ / ₈ (22)	3738

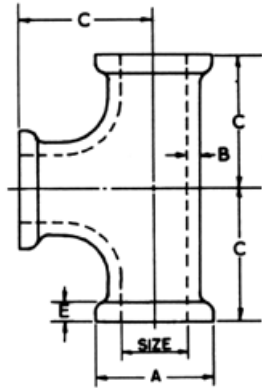
Tees

Size in (mm)	Part Number	Weight lbs (kg)	A in (mm)	B in (mm)	C in (mm)	E in (mm)	Price
1 (25)	CY17339Y	6 ³ / ₄ (3.1)	2 ¹ / ₁₆ (52)	³ / ₈ (10)	3 ¹ / ₂ (89)	⁷ / ₁₆ (11)	\$1178
1 ¹ / ₂ (40)	CY17339Z	11 (5.0)	2 ¹⁵ / ₁₆ (75)	³ / ₈ (10)	4 (101)	⁹ / ₁₆ (14)	1214
2 (50)	CY17339AB	15 ¹ / ₂ (7.0)	3 ⁹ / ₁₆ (90)	³ / ₈ (10)	4 ¹ / ₂ (114)	⁵ / ₈ (16)	1230
2 ¹ / ₂ (65)	CY17339AC	24 (10.9)	4 ⁵ / ₁₆ (110)	³ / ₈ (10)	5 (127)	⁵ / ₈ (16)	1276
3 (80)	CY17339AD	30 (13.6)	4 ¹³ / ₁₆ (122)	⁷ / ₁₆ (11)	5 ¹ / ₂ (140)	³ / ₄ (19)	1456
4 (100)	CY17339AE	45 (20.4)	6 ¹ / ₁₆ (154)	⁷ / ₁₆ (11)	6 ¹ / ₂ (165)	⁷ / ₈ (22)	2014
6 (150)	CY17339AG	83 (37.6)	8 ¹ / ₁₆ (205)	¹ / ₂ (13)	8 (229)	⁷ / ₈ (22)	3056
8 (200)	CY17339AH	134 (60.8)	10 ⁵ / ₁₆ (262)	⁵ / ₈ (16)	9 (229)	1 (25)	3156
10 (250)	CY17339AJ	188 (85.3)	12 ¹¹ / ₁₆ (322)	³ / ₄ (19)	11 (279)	¹ / ₈ (29)	6574
12 (300)	CY17339AK	235 (106.6)	15 ⁹ / ₁₆ (389)	⁷ / ₈ (22)	12 (305)	¹ / ₄ (32)	11258

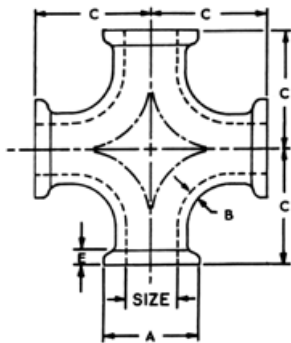
Crosses

Size in (mm)	Part Number	Weight lbs (kg)	A in (mm)	B in (mm)	C in (mm)	E in (mm)	Price
1 (25)	CY17339AL	8 (3.6)	2 ¹ / ₁₆ (52)	³ / ₈ (10)	3 ¹ / ₂ (89)	⁷ / ₁₆ (11)	\$1266
1 ¹ / ₂ (40)	CY17339AM	14 (6.4)	2 ¹⁵ / ₁₆ (75)	³ / ₈ (10)	4 (101)	⁹ / ₁₆ (14)	1310
2 (50)	CY17339AN	19 (8.6)	3 ⁹ / ₁₆ (90)	³ / ₈ (10)	4 ¹ / ₂ (114)	⁵ / ₈ (16)	1368
2 ¹ / ₂ (65)	CY17339AP	29 (13.2)	4 ⁵ / ₁₆ (110)	³ / ₈ (10)	5 (127)	⁵ / ₈ (16)	1674
3 (80)	CY17339AR	40 (18.1)	4 ¹³ / ₁₆ (122)	⁷ / ₁₆ (11)	5 ¹ / ₂ (140)	³ / ₄ (19)	1686
4 (100)	CY17339AS	58 (26.3)	6 ¹ / ₁₆ (154)	⁷ / ₁₆ (11)	6 ¹ / ₂ (165)	⁷ / ₈ (22)	1814
6 (150)	CY17339AT	96 (43.5)	8 ¹ / ₁₆ (205)	¹ / ₂ (13)	8 (203)	⁷ / ₈ (22)	4864
8 (200)	CY17339AU	166 (75.3)	10 ⁵ / ₁₆ (262)	⁵ / ₈ (16)	9 (229)	1 (25)	6184

Reducing Crosses

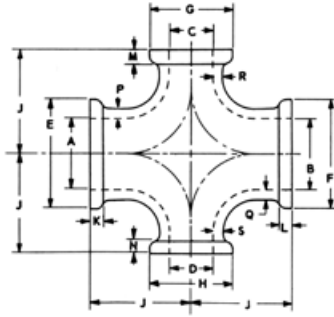

Part Number	Wt lbs (kg)	A in (mm)	B in (mm)	C in (mm)	D in (mm)	E in (mm)	F in (mm)	G in (mm)	H in (mm)	J in (mm)	K in (mm)	L in (mm)	M in (mm)	N in (mm)	P in (mm)	Q in (mm)	R in (mm)	S in (mm)	Price
BY17685A	8 ³ / ₄ (4.0)	1 ¹ / ₂ (38)	1 ¹ / ₂ (38)	1 (25)	1 (25)	2 ¹⁵ / ₁₆ (75)	2 ¹⁵ / ₁₆ (75)	2 ¹ / ₁₆ (52)	2 ¹ / ₁₆ (52)	4 (101)	9 ¹ / ₁₆ (14)	9 ¹ / ₁₆ (14)	9 ¹ / ₁₆ (14)	9 ¹ / ₁₆ (14)	3 ⁸ / ₁₆ (10)	3 ⁸ / ₁₆ (10)	3 ⁸ / ₁₆ (10)	3 ⁸ / ₁₆ (10)	\$ 1000
BY17685B	10 (4.5)	2 (51)	2 (51)	1 ¹ / ₂ (38)	1 ¹ / ₂ (38)	3 ⁹ / ₁₆ (90)	3 ⁹ / ₁₆ (90)	2 ¹⁵ / ₁₆ (75)	2 ¹⁵ / ₁₆ (75)	4 ¹ / ₂ (114)	5 ⁸ / ₁₆ (16)	5 ⁸ / ₁₆ (16)	9 ¹ / ₁₆ (14)	9 ¹ / ₁₆ (14)	3 ⁸ / ₁₆ (10)	3 ⁸ / ₁₆ (10)	3 ⁸ / ₁₆ (10)	3 ⁸ / ₁₆ (10)	1250
CY4397A	9 ¹ / ₂ (4.3)	2 (51)	2 (51)	2 (51)	1 (25)	3 ⁹ / ₁₆ (90)	3 ⁹ / ₁₆ (90)	3 ⁹ / ₁₆ (90)	2 ¹ / ₁₆ (52)	4 ¹ / ₂ (114)	5 ⁸ / ₁₆ (16)	5 ⁸ / ₁₆ (16)	5 ⁸ / ₁₆ (16)	9 ¹ / ₁₆ (14)	3 ⁸ / ₁₆ (10)	3 ⁸ / ₁₆ (10)	3 ⁸ / ₁₆ (10)	3 ⁸ / ₁₆ (10)	1446
BY17685C	14 (6.4)	2 (51)	2 (51)	2 (51)	1 ¹ / ₂ (38)	3 ⁹ / ₁₆ (90)	3 ⁹ / ₁₆ (90)	3 ⁹ / ₁₆ (90)	2 ¹⁵ / ₁₆ (75)	4 ¹ / ₂ (114)	5 ⁸ / ₁₆ (16)	5 ⁸ / ₁₆ (16)	5 ⁸ / ₁₆ (16)	9 ¹ / ₁₆ (14)	3 ⁸ / ₁₆ (10)	3 ⁸ / ₁₆ (10)	3 ⁸ / ₁₆ (10)	3 ⁸ / ₁₆ (10)	1504
BY17685D	20 (9.1)	3 (76)	2 (51)	2 (51)	2 (51)	4 ¹³ / ₁₆ (122)	3 ⁹ / ₁₆ (90)	3 ⁹ / ₁₆ (90)	3 ⁹ / ₁₆ (90)	5 ¹ / ₂ (140)	3 ⁴ / ₁₆ (19)	5 ⁸ / ₁₆ (16)	5 ⁸ / ₁₆ (16)	5 ⁸ / ₁₆ (16)	7 ¹ / ₁₆ (11)	7 ¹ / ₁₆ (11)	7 ¹ / ₁₆ (11)	7 ¹ / ₁₆ (11)	1686
BY17685E	21 ¹ / ₂ (9.8)	3 (76)	3 (76)	1 ¹ / ₂ (38)	1 ¹ / ₂ (38)	4 ¹³ / ₁₆ (122)	4 ¹³ / ₁₆ (122)	2 ¹⁵ / ₁₆ (75)	2 ¹⁵ / ₁₆ (75)	5 ¹ / ₂ (140)	3 ⁴ / ₁₆ (19)	3 ⁴ / ₁₆ (19)	5 ⁸ / ₁₆ (16)	5 ⁸ / ₁₆ (16)	7 ¹ / ₁₆ (11)	7 ¹ / ₁₆ (11)	3 ⁸ / ₁₆ (10)	3 ⁸ / ₁₆ (10)	2022
BY17685F	22 (10.0)	3 (76)	3 (76)	2 (51)	2 (51)	4 ¹³ / ₁₆ (122)	4 ¹³ / ₁₆ (122)	3 ⁹ / ₁₆ (90)	3 ⁹ / ₁₆ (90)	5 ¹ / ₂ (140)	3 ⁴ / ₁₆ (19)	3 ⁴ / ₁₆ (19)	5 ⁸ / ₁₆ (16)	5 ⁸ / ₁₆ (16)	7 ¹ / ₁₆ (11)	7 ¹ / ₁₆ (11)	7 ¹ / ₁₆ (11)	7 ¹ / ₁₆ (11)	2042
BY17685G	24 ³ / ₄ (11.2)	3 (76)	3 (76)	3 (76)	2 (51)	4 ¹³ / ₁₆ (122)	4 ¹³ / ₁₆ (122)	4 ¹³ / ₁₆ (122)	3 ⁹ / ₁₆ (90)	5 ¹ / ₂ (140)	3 ⁴ / ₁₆ (19)	3 ⁴ / ₁₆ (19)	3 ⁴ / ₁₆ (19)	5 ⁸ / ₁₆ (16)	7 ¹ / ₁₆ (11)	7 ¹ / ₁₆ (11)	7 ¹ / ₁₆ (11)	7 ¹ / ₁₆ (11)	2064
BY17685H	31 (14.1)	4 (101)	4 (101)	2 (51)	2 (51)	6 ¹ / ₁₆ (154)	6 ¹ / ₁₆ (154)	3 ⁹ / ₁₆ (90)	3 ⁹ / ₁₆ (90)	6 ¹ / ₂ (165)	7 ⁸ / ₁₆ (22)	7 ⁸ / ₁₆ (22)	5 ⁸ / ₁₆ (16)	5 ⁸ / ₁₆ (16)	7 ¹ / ₁₆ (11)	7 ¹ / ₁₆ (11)	3 ⁸ / ₁₆ (10)	3 ⁸ / ₁₆ (10)	2100
BY17685J	35 (15.9)	4 (101)	4 (101)	3 (76)	2 (51)	6 ¹ / ₁₆ (154)	6 ¹ / ₁₆ (154)	4 ¹³ / ₁₆ (122)	3 ⁹ / ₁₆ (90)	6 ¹ / ₂ (165)	7 ⁸ / ₁₆ (22)	7 ⁸ / ₁₆ (22)	3 ⁴ / ₁₆ (19)	5 ⁸ / ₁₆ (16)	7 ¹ / ₁₆ (11)	7 ¹ / ₁₆ (11)	7 ¹ / ₁₆ (11)	3 ⁸ / ₁₆ (10)	2134
BY17685K	36 (16.3)	4 (101)	4 (101)	4 (101)	2 (51)	6 ¹ / ₁₆ (154)	6 ¹ / ₁₆ (154)	6 ¹ / ₁₆ (154)	3 ⁹ / ₁₆ (90)	6 ¹ / ₂ (165)	7 ⁸ / ₁₆ (22)	7 ⁸ / ₁₆ (22)	7 ⁸ / ₁₆ (22)	5 ⁸ / ₁₆ (16)	7 ¹ / ₁₆ (11)	7 ¹ / ₁₆ (11)	7 ¹ / ₁₆ (11)	3 ⁸ / ₁₆ (10)	2172
BY17685L	75 (34.0)	6 (152)	6 (152)	4 (101)	4 (101)	8 ¹ / ₁₆ (205)	8 ¹ / ₁₆ (205)	6 ¹ / ₁₆ (154)	6 ¹ / ₁₆ (154)	8 (203)	7 ⁸ / ₁₆ (22)	7 ⁸ / ₁₆ (22)	3 ⁴ / ₁₆ (19)	3 ⁴ / ₁₆ (19)	1 ² / ₁₆ (13)	1 ² / ₁₆ (13)	1 ² / ₁₆ (13)	1 ² / ₁₆ (13)	4490
BY17685M	65 (29.5)	6 (152)	6 (152)	6 (152)	4 (101)	8 ¹ / ₁₆ (205)	8 ¹ / ₁₆ (205)	8 ¹ / ₁₆ (205)	6 ¹ / ₁₆ (154)	8 (203)	7 ⁸ / ₁₆ (22)	7 ⁸ / ₁₆ (22)	7 ⁸ / ₁₆ (22)	3 ⁴ / ₁₆ (19)	1 ² / ₁₆ (13)	1 ² / ₁₆ (13)	1 ² / ₁₆ (13)	1 ² / ₁₆ (13)	4574
BY17685N	110 (49.9)	8 (203)	8 (203)	8 (203)	4 (101)	10 ⁵ / ₁₆ (262)	10 ⁵ / ₁₆ (262)	10 ⁵ / ₁₆ (262)	6 ¹ / ₁₆ (154)	9 (229)	1 (25)	1 (25)	1 (25)	3 ⁴ / ₁₆ (19)	5 ⁸ / ₁₆ (16)	5 ⁸ / ₁₆ (16)	5 ⁸ / ₁₆ (16)	7 ¹ / ₁₆ (11)	4822

Split Flanged Reducing Tees

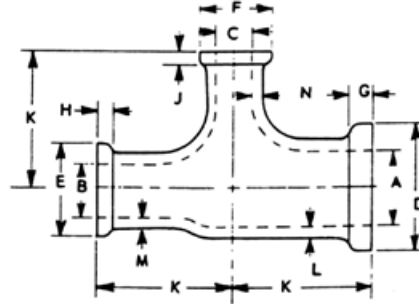

Part number	A (mm)	B (mm)	C (mm)	D (mm)	E (mm)	F (mm)	G (mm)	H (mm)	J (mm)	K (mm)	L (mm)	M (mm)	N (mm)	Price
BY17699A	1 (25)	1 (25)	1 1/2 (38)	2 1/16 (52)	2 1/16 (52)	2 15/16 (75)	9/16 (14)	9/16 (14)	9/16 (14)	4 (101)	5/16 (8)	5/16 (8)	5/16 (8)	\$ 1108
BY17699B	1 (25)	1 (25)	2 (51)	2 1/16 (52)	2 1/16 (52)	3 9/16 (90)	9/16 (14)	9/16 (14)	5/8 (16)	4 1/2 (114)	3/8 (10)	3/8 (10)	3/8 (10)	1152
BY17700A	1 1/2 (38)	1 (25)	1 (25)	2 15/16 (75)	2 1/16 (52)	2 1/16 (52)	9/16 (14)	9/16 (14)	9/16 (14)	4 (101)	3/8 (10)	3/8 (10)	3/8 (10)	2096
BY17700B	1 1/2 (38)	1 (25)	1 1/2 (38)	2 15/16 (75)	2 1/16 (52)	2 15/16 (75)	9/16 (14)	9/16 (14)	9/16 (14)	4 (101)	3/8 (10)	3/8 (10)	3/8 (10)	2230
BY17699D	1 1/2 (38)	1 1/2 (38)	1 (25)	2 15/16 (75)	2 15/16 (75)	2 1/16 (52)	9/16 (14)	9/16 (14)	9/16 (14)	4 (101)	3/8 (10)	3/8 (10)	3/8 (10)	2236
BY17699E	1 1/2 (38)	1 1/2 (38)	2 (51)	2 15/16 (75)	2 15/16 (75)	3 9/16 (90)	9/16 (14)	9/16 (14)	5/8 (16)	4 1/2 (114)	3/8 (10)	3/8 (10)	3/8 (10)	2268
BY17700C	2 (51)	1 (25)	1 (25)	3 9/16 (90)	2 1/16 (52)	2 1/16 (52)	5/8 (16)	9/16 (14)	9/16 (14)	4 1/2 (114)	3/8 (10)	3/8 (10)	3/8 (10)	2282
BY17700D	2 (51)	1 (25)	2 (51)	3 9/16 (90)	2 1/16 (52)	3 9/16 (90)	5/8 (16)	9/16 (14)	5/8 (16)	4 1/2 (114)	3/8 (10)	3/8 (10)	3/8 (10)	2294
BY17700E	2 (51)	1 1/2 (38)	1 1/2 (38)	3 9/16 (90)	2 15/16 (75)	2 15/16 (75)	5/8 (16)	9/16 (14)	9/16 (14)	4 1/2 (114)	3/8 (10)	3/8 (10)	3/8 (10)	2306
BY17700F	2 (51)	1 1/2 (38)	2 (51)	3 9/16 (90)	2 15/16 (75)	3 9/16 (90)	5/8 (16)	9/16 (14)	5/8 (16)	4 1/2 (114)	3/8 (10)	3/8 (10)	3/8 (10)	2348
BY17699F	2 (51)	2 (51)	1 (25)	3 9/16 (90)	3 9/16 (90)	2 1/16 (52)	5/8 (16)	5/8 (16)	9/16 (14)	4 1/2 (114)	3/8 (10)	3/8 (10)	3/8 (10)	2348
BY17699G	2 (51)	2 (51)	1 1/2 (38)	3 9/16 (90)	3 9/16 (90)	2 15/16 (75)	5/8 (16)	5/8 (16)	9/16 (14)	4 1/2 (114)	3/8 (10)	3/8 (10)	3/8 (10)	2352
BY17699H	2 (51)	2 (51)	3 (76)	3 9/16 (90)	3 9/16 (90)	4 13/16 (122)	5/8 (16)	5/8 (16)	3/4 (19)	5 1/2 (140)	3/8 (10)	3/8 (10)	7/16 (11)	2380
BY17699AK	2 (51)	2 (51)	4 (101)	3 9/16 (90)	3 9/16 (90)	6 1/16 (154)	5/8 (16)	5/8 (16)	7/8 (22)	6 1/2 (165)	3/8 (10)	3/8 (10)	7/16 (11)	2386
BY17700Y	2 1/2 (64)	2 (51)	2 1/2 (64)	4 5/16 (110)	3 9/16 (90)	4 5/16 (110)	5/8 (16)	5/8 (16)	5/8 (16)	5 (127)	3/8 (10)	3/8 (10)	3/8 (10)	2400
BY17699P	2 1/2 (64)	2 1/2 (64)	2 (51)	4 5/16 (110)	4 5/16 (110)	3 9/16 (90)	5/8 (16)	5/8 (16)	5/8 (16)	5 (127)	3/8 (10)	3/8 (10)	3/8 (10)	2400
BY17700J	3 (76)	1 (25)	2 (51)	4 13/16 (122)	2 1/16 (52)	3 9/16 (90)	3/4 (19)	9/16 (14)	5/8 (16)	5 1/2 (140)	7/16 (11)	3/8 (10)	3/8 (10)	2418
BY17700I	3 (76)	1 (25)	3 (76)	4 13/16 (122)	2 1/16 (52)	4 13/16 (122)	3/4 (19)	9/16 (14)	3/4 (19)	5 1/2 (140)	7/16 (11)	3/8 (10)	7/16 (11)	2426
BY17700Z	3 (76)	2 (51)	1 1/2 (38)	4 13/16 (122)	3 9/16 (90)	2 15/16 (75)	3/4 (19)	5/8 (16)	9/16 (14)	5 1/2 (140)	7/16 (11)	3/8 (10)	3/8 (10)	2458
BY17700G	3 (76)	2 (51)	2 (51)	4 13/16 (122)	3 9/16 (90)	3 9/16 (90)	3/4 (19)	5/8 (16)	5/8 (16)	5 1/2 (140)	7/16 (11)	3/8 (10)	3/8 (10)	2470
BY17700H	3 (76)	2 (51)	3 (76)	4 13/16 (122)	3 9/16 (90)	4 13/16 (122)	3/4 (19)	5/8 (16)	3/4 (19)	5 1/2 (140)	7/16 (11)	3/8 (10)	7/16 (11)	2482
BY17699K	3 (76)	3 (76)	1 (25)	4 13/16 (122)	4 13/16 (122)	2 1/16 (52)	3/4 (19)	3/4 (19)	9/16 (14)	5 1/2 (140)	7/16 (11)	7/16 (11)	3/8 (10)	2500
BY17699N	3 (76)	3 (76)	1 1/2 (38)	4 13/16 (122)	4 13/16 (122)	2 15/16 (75)	3/4 (19)	3/4 (19)	9/16 (14)	5 1/2 (140)	7/16 (11)	7/16 (11)	7/16 (11)	2500
BY17699L	3 (76)	3 (76)	2 (51)	4 13/16 (122)	4 13/16 (122)	3 9/16 (90)	3/4 (19)	3/4 (19)	5/8 (16)	5 1/2 (140)	7/16 (11)	7/16 (11)	7/16 (11)	2500
BY17699M	3 (76)	3 (76)	4 (101)	4 13/16 (122)	4 13/16 (122)	6 1/16 (154)	3/4 (19)	3/4 (19)	3/4 (19)	6 1/2 (165)	7/16 (11)	7/16 (11)	7/16 (11)	2536
BY17700K	4 (101)	2 (51)	1 (25)	6 1/16 (154)	3 9/16 (90)	2 1/16 (52)	7/8 (22)	5/8 (16)	9/16 (14)	6 1/2 (165)	7/16 (11)	3/8 (10)	3/8 (10)	2542
BY17700L	4 (101)	2 (51)	2 (51)	6 1/16 (154)	3 9/16 (90)	3 9/16 (90)	7/8 (22)	5/8 (16)	5/8 (16)	6 1/2 (165)	7/16 (11)	3/8 (10)	3/8 (10)	2542
BY17700M	4 (101)	2 (51)	3 (76)	6 1/16 (154)	3 9/16 (90)	4 13/16 (122)	7/8 (22)	5/8 (16)	3/4 (19)	6 1/2 (165)	7/16 (11)	7/16 (11)	7/16 (11)	2548
BY17700N	4 (101)	2 (51)	4 (101)	6 1/16 (154)	3 9/16 (90)	6 1/16 (154)	7/8 (22)	5/8 (16)	7/8 (22)	6 1/2 (165)	7/16 (11)	7/16 (11)	7/16 (11)	2562
BY17700P	4 (101)	3 (76)	4 (101)	6 1/16 (154)	4 13/16 (122)	6 1/16 (154)	7/8 (22)	3/4 (19)	7/8 (22)	6 1/2 (165)	7/16 (11)	7/16 (11)	7/16 (11)	2570
BY17699AJ	4 (101)	4 (101)	1 (25)	6 1/16 (154)	6 1/16 (154)	2 15/16 (75)	7/8 (22)	7/8 (22)	9/16 (14)	6 1/2 (165)	7/16 (11)	7/16 (11)	5/16 (8)	2580
BY17699Q	4 (101)	4 (101)	1 1/2 (38)	6 1/16 (154)	6 1/16 (154)	2 15/16 (75)	7/8 (22)	7/8 (22)	9/16 (14)	6 1/2 (165)	7/16 (11)	7/16 (11)	3/8 (10)	2580
BY17699R	4 (101)	4 (101)	2 (51)	6 1/16 (154)	6 1/16 (154)	3 9/16 (90)	7/8 (22)	7/8 (22)	5/8 (16)	6 1/2 (165)	7/16 (11)	7/16 (11)	3/8 (10)	2592
BY17699S	4 (101)	4 (101)	3 (76)	6 1/16 (154)	6 1/16 (154)	4 13/16 (122)	7/8 (22)	7/8 (22)	3/4 (19)	6 1/2 (165)	7/16 (11)	7/16 (11)	7/16 (11)	2596
BY17699AB	4 (101)	4 (101)	6 (152)	6 1/16 (154)	6 1/16 (154)	8 1/16 (205)	7/8 (22)	7/8 (22)	7/8 (22)	8 (203)	7/16 (11)	7/16 (11)	7/16 (11)	2618
BY17700T	6 (152)	2 (51)	6 (152)	8 1/16 (205)	3 9/16 (90)	8 1/16 (205)	7/8 (22)	5/8 (16)	7/8 (22)	8 (203)	1/2 (13)	3/8 (10)	1/2 (13)	3342
BY17700Q	6 (152)	4 (101)	3 (76)	8 1/16 (205)	6 1/16 (154)	4 13/16 (122)	7/8 (22)	7/8 (22)	3/4 (19)	8 (203)	1/2 (13)	7/16 (11)	7/16 (11)	3342
BY17700R	6 (152)	4 (101)	4 (101)	8 1/16 (205)	6 1/16 (154)	6 1/16 (154)	7/8 (22)	7/8 (22)	7/8 (22)	8 (203)	1/2 (13)	7/16 (11)	7/16 (11)	3360
BY17700S	6 (152)	4 (101)	6 (152)	8 1/16 (205)	6 1/16 (154)	8 1/16 (205)	7/8 (22)	7/8 (22)	7/8 (22)	8 (203)	1/2 (13)	7/16 (11)	1/2 (13)	3434
BY17699Z	6 (152)	6 (152)	1 (25)	8 1/16 (205)	8 1/16 (205)	2 1/16 (52)	7/8 (22)	7/8 (22)	9/16 (14)	8 (203)	1/2 (13)	1/2 (13)	3/8 (10)	3444
BY17699T	6 (152)	6 (152)	2 (51)	8 1/16 (205)	8 1/16 (205)	3 9/16 (90)	7/8 (22)	7/8 (22)	5/8 (16)	8 (203)	1/2 (13)	1/2 (13)	3/8 (10)	3452
BY17699AA	6 (152)	6 (152)	3 (76)	8 1/16 (205)	8 1/16 (205)	4 13/16 (122)	7/8 (22)	7/8 (22)	3/4 (19)	8 (203)	1/2 (13)	1/2 (13)	1/2 (13)	3470
BY17699U	6 (152)	6 (152)	4 (101)	8 1/16 (205)	8 1/16 (205)	6 1/16 (154)	7/8 (22)	7/8 (22)	3/4 (19)	8 (203)	1/2 (13)	1/2 (13)	7/16 (11)	3508
BY17700V	8 (203)	4 (101)	8 (203)	10 5/16 (262)	6 1/16 (154)	10 5/16 (262)	1 (25)	7/8 (22)	1 (25)	9 (229)	5/8 (16)	7/16 (11)	5/8 (16)	3664
BY17700W	8 (203)	6 (152)	6 (152)	10 5/16 (262)	8 1/16 (205)	8 1/16 (205)	1 (25)	7/8 (22)	7/8 (22)	9 (229)	5/8 (16)	1/2 (13)	1/2 (13)	3676
BY17700X	8 (203)	6 (152)	8 (203)	10 5/16 (262)	8 1/16 (205)	10 5/16 (262)	1 (25)	7/8 (22)	1 (25)	9 (229)	5/8 (16)	1/2 (13)	5/8 (16)	3684
BY17699W	8 (203)	8 (203)	3 (76)	10 5/16 (262)	10 5/16 (262)	4 13/16 (122)	1 (25)	1 (25)	3/4 (19)	9 (229)	5/8 (16)	5/8 (16)	1/2 (13)	3688
BY17699V	8 (203)	8 (203)	4 (101)	10 5/16 (262)	10 5/16 (262)	6 1/16 (154)	1 (25)	1 (25)	7/8 (22)	9 (229)	5/8 (16)	5/8 (16)	7/16 (11)	3692
BY17699X	8 (203)	8 (203)	6 (152)	10 5/16 (262)	10 5/16 (262)	8 1/16 (205)	1 (25)	1 (25)	7/8 (22)	9 (229)	5/8 (16)	5/8 (16)	1/2 (13)	3700
BY17699AD	10 (254)	10 (254)	6 (152)	12 11/16 (322)	12 11/16 (322)	8 1/16 (205)	1 1/8 (29)	1 1/8 (29)	7/8 (22)	11 (279)	3/4 (19)	3/4 (19)	1/2 (13)	6344
BY17699AE	10 (254)	10 (254)	8 (203)	12 11/16 (322)	12 11/16 (322)	10 5/16 (262)	1 1/8 (29)	1 1/8 (29)	1 (25)	11 (279)	3/4 (19)	3/4 (19)	5/8 (16)	7324

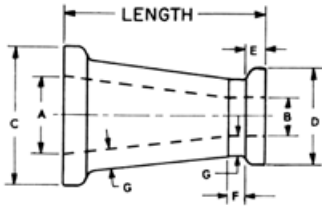
Split Flange Reducers

Part Number	A in (mm)	B in (mm)	C in (mm)	D in (mm)	E in (mm)	F in (mm)	G in (mm)	Length in (mm)	Price
PH3659B	1 (25)	1½ (38)	2 ¹⁵ / ₁₆ (75)	2 ⁷ / ₁₆ (52)	9/16 (14)	9/16 (14)	5/16 (8)	5 (127)	\$ 400
PH3659H	1¼ (32)	1½ (38)	2 ¹⁵ / ₁₆ (75)	2 ⁷ / ₁₆ (62)	9/16 (14)	9/16 (14)	5/16 (8)	5 (127)	458
PH3659C	1 (25)	2 (51)	3 ⁹ / ₁₆ (90)	2 ¹ / ₁₆ (52)	5/8 (16)	9/16 (14)	3/8 (10)	5 (127)	750
PH3659M	1½ (38)	2 (51)	3 ⁹ / ₁₆ (90)	2 ¹⁵ / ₁₆ (75)	5/8 (16)	9/16 (14)	3/8 (10)	5 (127)	762
PH3659D	1 (25)	2½ (64)	4 ⁵ / ₁₆ (110)	2 ¹ / ₁₆ (52)	5/8 (16)	9/16 (14)	3/8 (10)	5 (127)	768
PH3659N	1½ (38)	2½ (64)	4 ⁵ / ₁₆ (110)	2 ¹⁵ / ₁₆ (75)	5/8 (16)	9/16 (14)	3/8 (10)	5 (127)	784
PH3659T	2 (51)	2½ (64)	4 ⁵ / ₁₆ (110)	3 ⁹ / ₁₆ (90)	5/8 (16)	9/16 (14)	3/8 (10)	5 (127)	800
PH3659E	1 (25)	3 (76)	4 ¹³ / ₁₆ (122)	2 ¹ / ₁₆ (52)	3/4 (19)	5/8 (16)	7/16 (11)	6 (152)	860
PH3659P	1½ (38)	3 (76)	4 ¹³ / ₁₆ (122)	2 ¹⁵ / ₁₆ (75)	3/4 (19)	5/8 (16)	7/16 (11)	6 (152)	876
PH3659U	2 (51)	3 (76)	4 ¹³ / ₁₆ (122)	3 ⁹ / ₁₆ (90)	3/4 (19)	5/8 (16)	7/16 (11)	6 (152)	892
PH3659Z	2½ (64)	3 (76)	4 ¹³ / ₁₆ (122)	4 ⁵ / ₁₆ (110)	3/4 (19)	5/8 (16)	7/16 (11)	6 (152)	900
PH3659F	1 (25)	4 (101)	6 ¹ / ₁₆ (154)	2 ¹ / ₁₆ (52)	7/8 (22)	1 ¹ / ₁₆ (17)	7/16 (11)	7 (179)	1026
PH3659R	1½ (38)	4 (101)	6 ¹ / ₁₆ (154)	2 ¹⁵ / ₁₆ (75)	7/8 (22)	1 ¹ / ₁₆ (17)	7/16 (11)	7 (179)	1034
PH3659V	2 (51)	4 (101)	6 ¹ / ₁₆ (154)	3 ⁹ / ₁₆ (90)	7/8 (22)	1 ¹ / ₁₆ (17)	7/16 (11)	7 (179)	1092
PH3659AA	2½ (64)	4 (101)	6 ¹ / ₁₆ (154)	4 ⁵ / ₁₆ (110)	7/8 (22)	1 ¹ / ₁₆ (17)	7/16 (11)	7 (179)	1098
PH3659AD	3 (76)	4 (101)	6 ¹ / ₁₆ (154)	4 ¹³ / ₁₆ (122)	7/8 (22)	1 ¹ / ₁₆ (17)	7/16 (11)	7 (179)	1116
PH3659W	2 (51)	5 (127)	7 ¹ / ₁₆ (179)	3 ⁹ / ₁₆ (90)	7/8 (22)	1 ¹ / ₁₆ (17)	1/2 (13)	8 (203)	1370
PH3659AE	3 (76)	5 (127)	7 ¹ / ₁₆ (179)	4 ¹³ / ₁₆ (122)	7/8 (22)	1 ¹ / ₁₆ (17)	1/2 (13)	8 (203)	1400
PH3659AH	4 (101)	5 (127)	7 ¹ / ₁₆ (179)	6 ¹ / ₁₆ (154)	7/8 (22)	1 ¹ / ₁₆ (17)	1/2 (13)	8 (203)	1450
PH3659S	1½ (38)	6 (152)	8 ¹ / ₁₆ (205)	2 ¹⁵ / ₁₆ (75)	7/8 (22)	1 ¹ / ₁₆ (17)	1/2 (13)	9 (229)	1770
PH3659X	2 (51)	6 (152)	8 ¹ / ₁₆ (205)	3 ⁹ / ₁₆ (90)	7/8 (22)	1 ¹ / ₁₆ (17)	1/2 (13)	9 (229)	1774
PH3659AC	2½ (64)	6 (152)	8 ¹ / ₁₆ (205)	4 ⁵ / ₁₆ (110)	7/8 (22)	1 ¹ / ₁₆ (17)	1/2 (13)	9 (229)	1782
PH3659AF	3 (76)	6 (152)	8 ¹ / ₁₆ (205)	4 ¹³ / ₁₆ (122)	7/8 (22)	1 ¹ / ₁₆ (17)	1/2 (13)	9 (229)	1792
PH3659AJ	4 (101)	6 (152)	8 ¹ / ₁₆ (205)	6 ¹ / ₁₆ (154)	7/8 (22)	1 ¹ / ₁₆ (17)	1/2 (13)	9 (229)	1818
PH3659AM	5 (127)	6 (152)	8 ¹ / ₁₆ (205)	7 ¹ / ₁₆ (179)	7/8 (22)	1 ¹ / ₁₆ (17)	1/2 (13)	9 (229)	1840
PH3659Y	2 (51)	8 (203)	10 ⁵ / ₁₆ (262)	3 ⁹ / ₁₆ (90)	1 (25)	7/8 (22)	5/8 (16)	11 (279)	1882
PH3659AG	3 (76)	8 (203)	10 ⁵ / ₁₆ (262)	4 ¹³ / ₁₆ (122)	1 (25)	7/8 (22)	5/8 (16)	11 (279)	1892
PH3659AK	4 (101)	8 (203)	10 ⁵ / ₁₆ (262)	6 ¹ / ₁₆ (154)	1 (25)	7/8 (22)	5/8 (16)	11 (279)	2010
PH3659AP	6 (152)	8 (203)	10 ⁵ / ₁₆ (262)	8 ¹ / ₁₆ (205)	1 (25)	7/8 (22)	5/8 (16)	11 (279)	2014
PH3659AS	6 (152)	10 (254)	12 ¹¹ / ₁₆ (322)	8 ¹ / ₁₆ (205)	1 ¹ / ₈ (29)	1 (25)	3/4 (19)	12 (305)	2362
PH3659AV	8 (203)	10 (254)	12 ¹¹ / ₁₆ (322)	10 ⁵ / ₁₆ (262)	1 ¹ / ₈ (29)	1 (25)	3/4 (19)	12 (305)	2830
PH3659AT	6 (152)	12 (305)	15 ⁵ / ₁₆ (389)	8 ¹ / ₁₆ (205)	1 ¹ / ₄ (32)	1 (25)	7/8 (22)	14 (356)	3144
PH3659AW	8 (203)	12 (305)	15 ⁵ / ₁₆ (389)	10 ⁵ / ₁₆ (262)	1 ¹ / ₄ (32)	1 (25)	7/8 (22)	14 (356)	3156
PH3659AZ	10 (254)	12 (305)	15 ⁵ / ₁₆ (389)	12 ¹¹ / ₁₆ (322)	1 ¹ / ₄ (32)	1 (25)	7/8 (22)	14 (356)	3260

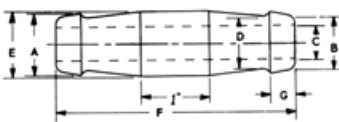
Hose Couplings

Hose Size in (mm)	Part Number	A in (mm)	B in (mm)	C in (mm)	D in (mm)	E in (mm)	F in (mm)	G in (mm)	Price
¾ (19)	D7407	7/8 (22)	¾ (19)	½ (13)	¾ (19)	15/16 (24)	5 (127)	3/8 (10)	\$ 42
1 (25)	D7408	1 1/8 (29)	1 (25)	¾ (19)	1 (25)	1 3/16 (30)	5 1/2 (140)	3/8 (10)	46
1¼ (32)	K3509	1 3/8 (35)	1 ¼ (32)	1 (25)	1 ¼ (32)	1 7/16 (37)	6 (152)	3/8 (10)	55
1½ (40)	D7410A	1 5/8 (41)	1 ½ (38)	1 1/8 (29)	1 ½ (38)	1 11/16 (43)	6 (152)	3/8 (10)	67
2 (50)	D7411	2 3/16 (56)	2 1/16 (52)	1 5/8 (41)	2 (51)	2 5/16 (59)	7 (179)	1/2 (13)	120
2½ (64)	D7412	2 11/16 (68)	2 9/16 (65)	2 (51)	2 ½ (64)	2 13/16 (71)	8 (203)	5/8 (16)	126
3 (80)	D7413	3 3/16 (81)	3 1/16 (78)	2 ½ (64)	3 (76)	3 5/16 (84)	9 (229)	5/8 (16)	143
4 (100)	AS1103A	4 3/16 (106)	4 1/16 (103)	3 3/8 (86)	4 (101)	4 3/8 (111)	10 (254)	¾ (19)	798

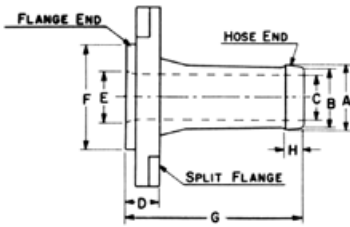
Hose Connections

Flange Size in (mm)	Hose Size in (mm)	Part Number	A in (mm)	B in (mm)	C in (mm)	D in (mm)	F in (mm)	G in (mm)	H in (mm)	Price
1 (25)	1/2 (15)	PSP392A	9/16 (14)	1/2 (13)	1/4 (6)	15/16 (24)	2 1/16 (52)	2 1/4 (57)	3/16 (5)	\$ 432
1 (25)	3/4 (20)	PSP392B	7/8 (22)	3/4 (19)	1/2 (13)	15/16 (24)	2 1/16 (52)	3 (76)	3/8 (10)	432
1 (25)	1 (25)	PSP392C	1 1/8 (29)	1 (25)	3/4 (19)	13/16 (21)	2 1/16 (52)	3 (76)	5/16 (8)	432
1 (25)	1 1/4 (32)	PSP392D	1 3/8 (35)	1 1/4 (32)	15/16 (24)	13/16 (21)	2 1/16 (52)	4 (101)	5/16 (8)	432
1 (25)	1 1/2 (40)	PSP392E	1 5/8 (41)	1 1/2 (38)	13/16 (30)	7/8 (22)	2 1/16 (52)	4 (101)	3/8 (10)	432
1 1/2 (40)	1 (25)	PSP392H	1 1/8 (29)	1 (25)	3/4 (19)	7/8 (22)	2 15/16 (75)	3 1/2 (89)	5/16 (8)	460
1 1/2 (40)	1 1/4 (32)	PSP392J	1 3/8 (35)	1 1/4 (32)	15/16 (24)	7/8 (22)	2 15/16 (75)	4 (101)	5/16 (8)	488
1 1/2 (40)	1 1/2 (40)	PSP392K	1 5/8 (41)	1 1/2 (38)	13/16 (30)	7/8 (22)	2 15/16 (75)	4 (101)	3/8 (10)	488
1 1/2 (40)	2 (50)	PSP392L	2 3/16 (56)	2 1/16 (52)	1 5/8 (41)	7/8 (22)	2 15/16 (75)	4 (101)	3/8 (10)	490
2 (50)	1 (25)	PSP392M	1 1/8 (29)	1 (25)	3/4 (19)	7/8 (22)	3 9/16 (90)	3 3/4 (95)	5/16 (8)	510
2 (50)	1 1/4 (32)	PSP392N	1 3/8 (35)	1 1/4 (32)	15/16 (24)	7/8 (22)	3 9/16 (90)	4 (101)	5/16 (8)	510
2 (50)	1 1/2 (40)	PSP392P	1 5/8 (41)	1 1/2 (38)	13/16 (30)	7/8 (22)	3 9/16 (90)	4 1/4 (108)	3/8 (10)	510
2 (50)	2 (50)	PSP392Q	2 3/16 (56)	2 1/16 (52)	1 5/8 (41)	7/8 (22)	3 9/16 (90)	4 1/4 (108)	3/8 (10)	510
2 (50)	2 1/2 (65)	PSP392R	2 1 1/16 (68)	2 9/16 (65)	2 (51)	7/8 (22)	3 9/16 (90)	4 1/2 (114)	1/2 (13)	510
2 (50)	3 (80)	PSP392S	3 3/16 (81)	3 1/16 (78)	3 (76)	15/16 (24)	3 9/16 (90)	5 (127)	5/8 (16)	532
2 1/2 (65)	2 (50)	PSP392T	2 3/16 (56)	2 1/16 (52)	1 5/8 (41)	13/16 (21)	4 5/16 (110)	4 1/4 (108)	3/8 (10)	546
2 1/2 (65)	2 1/2 (65)	PSP392U	2 1 1/16 (68)	2 9/16 (65)	2 (51)	13/16 (21)	4 5/16 (110)	4 1/2 (114)	1/2 (13)	546
2 1/2 (65)	3 (80)	PSP392V	3 3/16 (81)	3 1/16 (78)	2 1/2 (64)	7/8 (22)	4 5/16 (110)	5 (127)	5/8 (16)	558
3 (80)	2 (51)	PSP392W	2 3/16 (56)	2 1/16 (52)	1 5/8 (41)	1 (25)	4 13/16 (122)	4 1/2 (114)	3/8 (10)	570
3 (80)	2 1/2 (65)	PSP392X	2 1 1/16 (68)	2 9/16 (65)	2 (51)	1 (25)	4 13/16 (122)	4 1/2 (114)	1/2 (13)	576
3 (80)	3 (76)	PSP392Y	3 3/16 (81)	3 1/16 (78)	2 1/2 (64)	1 3/16 (30)	4 13/16 (122)	5 (127)	5/8 (16)	702
3 (80)	3 (80)	PSP392Z	3 3/16 (81)	3 1/16 (78)	2 1/2 (64)	1 3/16 (30)	4 13/16 (122)	8 (203)	5/8 (16)	702
3 (80)	3 1/2 (89)	PSP392AB	3 1 1/16 (94)	3 9/16 (90)	3 (76)	1 3/16 (30)	4 13/16 (122)	5 1/2 (140)	5/8 (16)	840
3 (80)	4 (100)	PSP392AC	4 1/16 (103)	3 13/16 (97)	3 (76)	1 3/16 (30)	4 13/16 (122)	6 (152)	5/8 (16)	880
4 (100)	2 (50)	PSP392AF	2 3/16 (56)	2 1/16 (52)	1 5/8 (41)	1 1/16 (27)	6 1/16 (154)	4 3/4 (121)	3/8 (10)	1100
4 (100)	3 (80)	AY1321A	3 3/16 (81)	3 1/16 (78)	2 1/2 (64)	1 3/16 (30)	6 1/16 (154)	6 (152)	3/4 (19)	1222
4 (100)	4 (100)	PSP392AE	4 3/16 (106)	4 1/16 (103)	3 3/8 (86)	1 1/4 (32)	6 1/16 (154)	6 (152)	7/8 (22)	1236
6 (150)	6 (150)	PSP392AF	6 3/16 (157)	6 1/16 (154)	5 3/8 (137)	1 3/8 (35)	8 1/16 (205)	8 1/2 (216)	7/8 (22)	1262

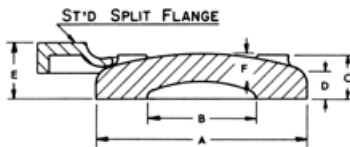
Blank Flanges

Size in (mm)	Part Number	Weight lbs (kg)	A in (mm)	B in (mm)	C in (mm)	D in (mm)	E in (mm)	F in (mm)	Price
1 (25)	P10571A	1/2 (0.2)	2 1/16 (52)	1 (25)	5/8 (16)	3/8 (10)	25/32 (20)	3/8 (10)	\$ 236
1 1/2 (40)	P10571B	1 (0.5)	2 15/16 (75)	1 1/2 (38)	5/8 (16)	3/8 (10)	27/32 (21)	3/8 (10)	316
2 (50)	P10571C	1 1/2 (0.7)	3 9/16 (90)	2 (51)	5/8 (16)	3/8 (10)	27/32 (21)	3/8 (10)	406
2 1/2 (65)	P10571D	2 (0.9)	4 5/16 (110)	2 1/2 (64)	3/4 (19)	3/8 (10)	31/32 (25)	3/8 (10)	406
3 (80)	P10571E	3 (1.4)	4 13/16 (122)	3 (76)	7/8 (22)	7/16 (11)	1 1/32 (26)	7/16 (11)	414
4 (100)	P10571F	4 1/2 (2.0)	6 1/16 (154)	4 (101)	1 (25)	1/2 (13)	1 3/16 (30)	1/2 (13)	456
6 (150)	P10571G	10 1/2 (4.8)	8 1/16 (205)	6 (152)	1 1/2 (38)	5/8 (16)	1 9/16 (40)	5/8 (16)	538
8 (200)	P10571H	18 (8.2)	10 5/16 (262)	8 (203)	1 3/4 (44)	3/4 (19)	1 5/8 (41)	3/4 (19)	600
10 (250)	P10571J	31 (14.1)	12 1 1/16 (322)	10 (254)	2 (51)	1 (25)	1 27/32 (47)	7/8 (22)	716

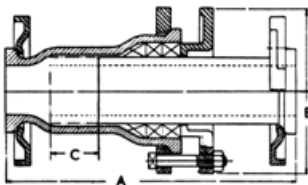
Expansion Joints

Size in (mm)	Part Number	Weight with Flange lbs (kg)	A in (mm)	B in (mm)	C in (mm)	Price
1 (25)	Y33826A	15 (6.8)	10 (254)	5 5/8 (143)	1 (25)	\$ 1600
1 1/2 (40)	Y33826B	22 (10.0)	10 (254)	6 1/4 (159)	1 1/4 (32)	1900
2 (50)	Y33826C	30 (13.6)	13 (330)	7 (179)	2 (51)	2670
3 (80)	Y33826E	48 (21.8)	14 (356)	8 1/4 (210)	2 (51)	3700
4 (100)	Y33826F	66 (29.9)	14 (356)	10 (254)	2 1/4 (57)	5000

Materials Engineering

Multiple Casting Processes

Reactive Alloy Expertise

Rapid Prototyping

Technical Support



Flowserve Corporation
Foundry Operations
635 North Irwin Street
Dayton, OH 45403 USA
Telephone: 1 937 226 4568
Fax: 1 937 226 4068
E-mail: durironpipe@flowserve.com
web site: www.flowserve.com

Your local Flowserve representative:

Flowserve has numerous manufacturing, sales, and service operations throughout the world. Please contact one of the regional centers to determine the location of the nearest office.