

BUTTERFLY VALVE

6100 SERIES

2"-12" - 200 PSI (1380 kPa)

RATINGS

200 PSI Butterfly Valve
Non Shock Water, Oil,
Gas

SPECIFICATIONS

MSS SP-67
API-609

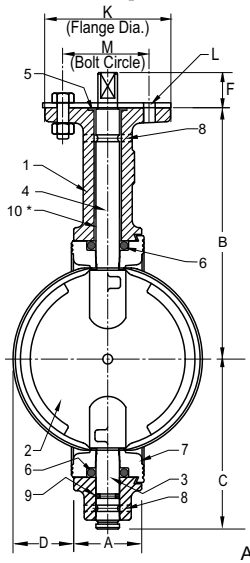

For Dead End Applications Use Hammond Valve "6200" Products.

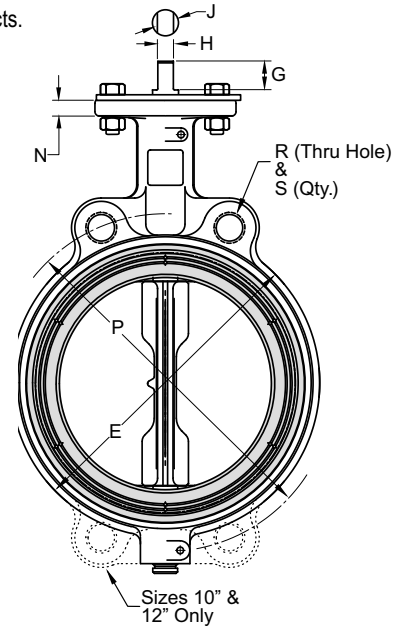
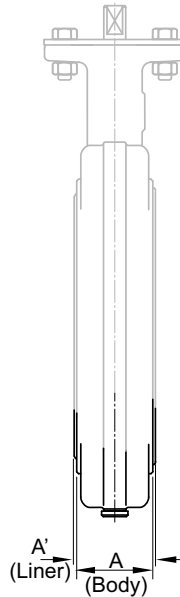

ITEM	PARTS NAME	MATERIAL
1	BODY	CAST IRON-ASTM A 126 CL B
		CAST IRON-EPOXY COATED
		CAST IRON-NYLON COATED
		DUCTILE IRON-ASTM A 536
		DUCTILE IRON-EPOXY COATED
		DUCTILE IRON-NYLON COATED
2	DISC	NP DUCTILE IRON-ASTM A 536
		ALUMINUM BRONZE-ASTM B 148
		STAINLESS STEEL-TYPE 316
3	BOTTOM STEM	NYLON COATED DUCTILE IRON
		EPOXY COATED DUCTILE IRON
		STAINLESS STEEL TYPE 416
4	TOP STEM	STAINLESS STEEL TYPE 316
		STAINLESS STEEL TYPE 416
5	TOP BEARING	STAINLESS STEEL TYPE 316
6	SEAL	THERMOSET POLYMER
		EPDM, BUNA, VITON(1)
		BUNA
		EPDM
		VITON
		VITON-GFLT
		HYPALON
7	LINER	NEOPRENE BLACK-FDA
		NEOPRENE WHITE-FDA
		TEFLON OVER BUNA (#50# WOG)
		STAINLESS STEEL TYPE 416
		STAINLESS STEEL TYPE 316
8	ROLL PIN	STAINLESS STEEL
9	STEM SEAL	EPDM, BUNA, VITON(1)
10*	LOWER BEARING	THERMOSET POLYMER
11	OPERATOR	LEVER HANDLE
		EPOXY COATED LEVER
		GEAR OPERATOR
		GEAR OP W/ MEMORY STOP
		GEAR OP W/ LOCK
		ACTUATOR-AIR/AIR
		ACTUATOR-AIR/SPRING
ACTUATOR-ELECTRIC		

DIMENSIONS

	INCHES	2	2-1/2	3	4	5	6	8	10	12
A (Body)	INCHES	1.69	1.81	1.81	2.07	2.19	2.19	2.38	2.69	3.06
	mm	42.9	46.1	46.0	52.5	55.6	55.6	60.3	68.3	78.0
A' (Liner)	INCHES	1.82	1.94	1.94	2.20	2.32	2.31	2.51	2.82	3.21
	mm	46.1	49.1	49.1	55.8	58.8	58.7	63.6	71.5	82.0
B	INCHES	5.50	6.00	6.25	7.00	7.53	8.00	9.38	10.19	12.06
	mm	139.7	152.4	158.8	177.8	191.3	203.2	238.1	258.8	306.4
C	INCHES	3.06	3.31	3.75	4.25	4.94	5.56	6.56	7.88	9.25
	mm	77.8	84.1	95.3	108.0	125.4	141.3	166.7	200.0	235.0
D (Chord Dia)	INCHES	1.49	2.01	2.64	3.67	4.71	5.66	7.72	9.70	11.68
	mm	37.8	51.1	67.1	93.2	119.6	143.8	196.1	246.4	296.7
D' (Intrusion)	INCHES	0.28	0.44	0.69	1.06	1.50	1.94	2.84	3.69	4.50
	mm	7.1	11.1	17.5	27.0	38.1	49.2	72.2	93.7	114.3
E	INCHES	4.13	4.88	5.38	6.88	7.75	8.75	11.00	13.38	16.13
	mm	104.8	123.8	136.5	174.6	196.9	222.3	279.4	339.7	409.6
F	INCHES	1.13	1.13	1.13	1.13	1.13	1.13	1.50	1.50	1.50
	mm	28.6	28.6	28.6	28.6	28.6	28.6	38.1	38.1	38.1
G	INCHES	0.81	0.81	0.81	0.81	0.81	0.81	1.06	1.06	1.06
	mm	20.6	20.6	20.6	20.6	20.6	20.6	27.0	27.0	27.0
H	INCHES	0.35	0.35	0.35	0.40	0.40	0.44	0.53	0.71	0.71
	mm	8.9	8.9	8.9	10.2	10.2	11.2	13.5	18.0	18.0
J	INCHES	0.50	0.50	0.50	0.56	0.56	0.62	0.75	1.00	1.00
	mm	12.6	12.6	12.6	14.2	14.2	15.8	19.0	25.4	25.4
K		4	4	4	4	4	4	6	6	6
L	INCHES	0.44	0.44	0.44	0.44	0.44	0.44	0.56	0.56	0.56
	mm	11.1	11.1	11.1	11.1	11.1	11.1	14.3	14.3	14.3
M	INCHES	3.25	3.25	3.25	3.25	3.25	3.25	5.00	5.00	5.00
	mm	82.6	82.6	82.6	82.6	82.6	82.6	127.0	127.0	127.0
N	INCHES	0.44	0.44	0.44	0.44	0.44	0.44	0.50	0.50	0.50
	mm	11.1	11.1	11.1	11.1	11.1	11.1	12.7	12.7	12.7
P	INCHES	4.75	5.50	6.00	7.50	8.50	9.50	11.75	14.25	17.00
	mm	120.7	139.7	152.4	190.5	215.9	241.3	298.5	362.0	431.8
R		5/8-11	5/8-11	5/8-11	5/8-11	3/4-10	3/4-10	3/4-10	7/8-9	7/8-9
S		2	2	2	2	2	2	2	4	4

(1) VITON O-RINGS ARE USED WITH HYPALON, NEOPRENE, AND TEFLON LINERS. * Provided on 8", 10", 12".

Rev. 2

The information presented on this sheet is correct at the time of publication. Hammond Valve reserves the right to change design, and/or material specifications without notice. For the Installation, Operation and Maintenance Manual (IOM) see the engineering section on our website. For the most current information access www.hammondvalve.com

BFV-4

