

CHECK IB904

HORIZONTAL SWING – BRONZE

125 lb. SWP-200 lb. WOG† • General Service
• Threaded Ends

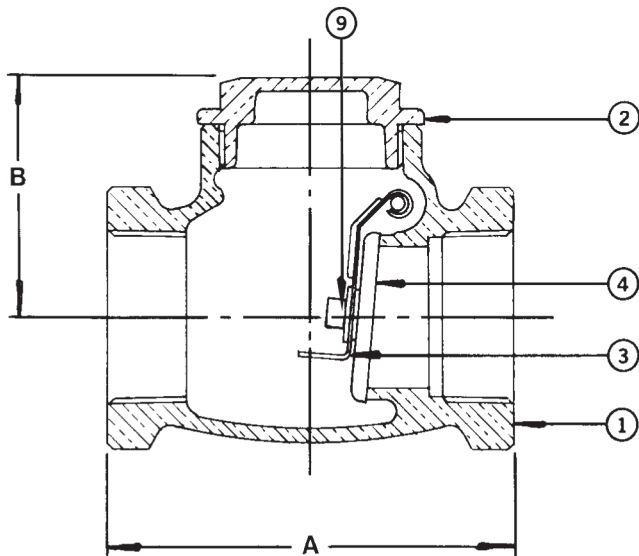

SPECIFICATIONS

IB904	Conforms to: MSS SP-80. Type 3, Class 125, Threaded Ends.
-------	--

MATERIAL LIST

NO.	PART	MATERIAL	SPECIFICATION
1	Body	Bronze	ASTM B 62
2	Cap	Bronze	ASTM B 62
3	Lever	St. Steel	Commercial 1/4" to 2" Incl.
		Bronze	ASTM B 62 2 1/2" and 3"
4	Disc	Brass	ASTM B 16 1/4" to 3/4" Incl. ASTM B 62 1" to 3" Incl.
5	Pin	St. Steel	Commercial
6	Plug (not shown)	Brass	ASTM B 16
7 ¹	Washer	Bronze	Commercial
8 ¹	Disc Nut	Bronze	Commercial
9	Retaining Ring	St. Steel	Commercial

¹ Used on 2 1/2" and 3" sizes only

DIMENSIONS - INCHES / MILLIMETERS

UNITS	SIZE	A	B	C _v
Inches	1/4	2.13	1.44	3.3
mm	6.35	53.98	36.53	3.3
Inches	3/8	2.13	1.44	6.0
mm	9.53	53.98	36.53	6.0
Inches	1/2	2.31	1.44	10.0
mm	12.70	58.75	36.53	10.0
Inches	3/4	2.63	1.69	18.0
mm	19.05	66.68	42.88	18.0
Inches	1	3.25	2.00	31.0
mm	25.40	82.55	50.80	31.0
Inches	1 1/4	3.56	2.13	54.0
mm	31.75	90.50	53.98	54.0
Inches	1 1/2	4.00	2.38	76.0
mm	38.10	101.60	60.33	76.0
Inches	2	4.75	2.81	131.0
mm	50.80	130.18	207.98	131.0
Inches	2 1/2	6.00	3.63	192.0
mm	63.50	152.40	92.08	192.0
Inches	*3	6.88	4.19	297.0
mm	76.20	174.63	106.38	297.0

† Non-Shock

Rev. 4

BETTER AT EVERY TURN



HAMMONDVALVE
www.hammondvalve.com

The information presented on this sheet is correct at the time of publication. Hammond Valve reserves the right to change design, and/or material specifications without notice. For the Installation, Operation and Maintenance Manual (IOM) see the engineering section on our website. For the most current information access www.hammondvalve.com