

PEXRITE®

Pick Your Stub-Out Method

PEX **PEXRITE® TURN-OUT #704**

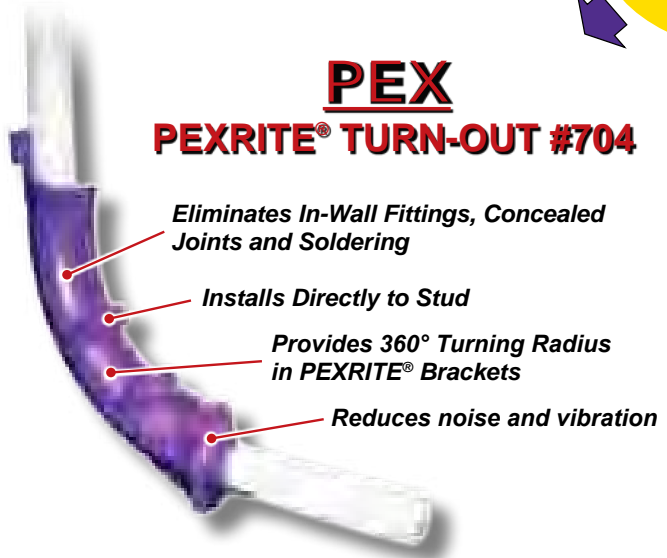

- Eliminates In-Wall Fittings, Concealed Joints and Soldering*
- Installs Directly to Stud*
- Provides 360° Turning Radius in PEXRITE® Brackets*
- Reduces noise and vibration*

COPPER **PEXRITE® LOCK-N-LOAD™ #701**



- Designed for PEX, Copper and CPVC*
- Tightens by Hand - No tools or hardware required*
- Eliminates Soldering*
- Secure fit prevents forward and backward movement*

#103-18



PEXRITE TURN-OUT #704 INSTALLATION INSTRUCTIONS

- 1** Install PEXRITE® bracket to studs
- 2** Insert 704 into bracket from the front
- 3** Position 704 until bracket fits into groove, then rotate into place
- 4** Insert PEX tube at 45° angle and set stub-out length
- 5** Bend tube forward and snap into 704
- 6** No concealed joint in the wall

PEXRITE LOCK-N-LOAD #701 INSTALLATION INSTRUCTIONS

- 1** Install PEXRITE® bracket to studs
- 2** Insert 701 into bracket from front
- 3** Lock 701 into bracket with thumbs
- 4** Load tubing through 701 from back
- 5** Push and twist back nut by hand until tight
- 6** Secures stub-out with no solder

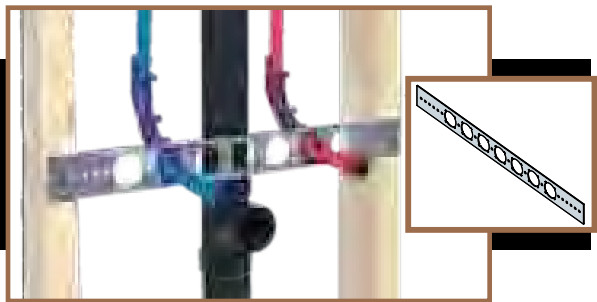

HOLDRITE – #103-18, #103-26

- Versatile bracket ideal for sink, lavatory & water closet plumbing solutions
- Galvanized steel bracket with 1-3/8" keyed holes on 2" centers
- Integrates with PEXRITE #701 & #704 with patented connection and other HOLDRITE inserts

Model#	Bracket Size	For Pipe Size(s)	Box Qty
103-18	20"	1/2", 3/4", 1" CTS	50
103-26	26"	1/2", 3/4", 1" CTS	50



PEXRITE – #704

- PEX turnout integrates with #103, #110-R, and #709 series brackets
- Install directly to stud
- Reduces in-wall fittings and concealed joints
- Provides 360-degree turning radius
- Torch-free environment at stub-out location
- Eliminates the need for costly copper bullets
- Compatible with all PEX tubing manufacturers

Model#	Size	For Pipe Size(s)	Box Qty
704	3-1/4" X 5-1/2"	3/8" - 1/2" CTS	100

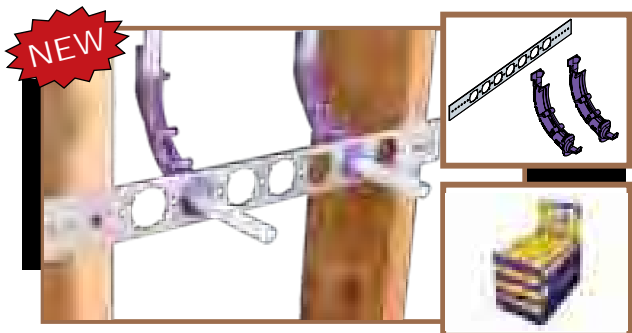

PEXRITE – #704-PR KIT

- PEX stub-out kit for lavatory/sink or toilet
- Includes (1) #103-18 galvanized bracket and (2) #704 turn-outs
- Installation photos on packaging. Great for Counter Sales.
- Available in Contractor kit, 6PAK, and Wholesaler point-of-purchase (POP) display

Model#	For Pipe Size(s)	Kit Qty	6PAK Qty	Case Qty
704-PR	3/8" - 1/2" CTS	1	6	36

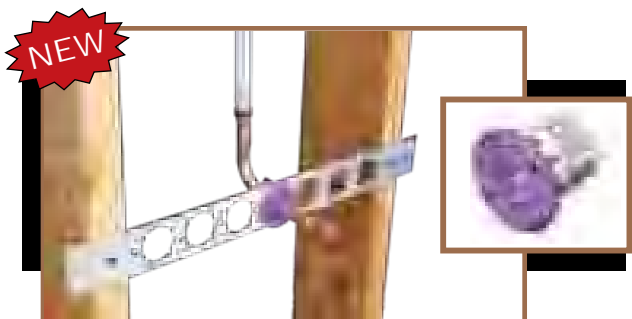

HOLDRITE LOCK-N-LOAD™ – #701

- Stub-out clamp ideal for 1/2" CTS PEX-to-Copper transition at lavatory/sink or toilet
- Integrates with #103, #110-R, and #709 series brackets
- Compatible with PEX, Copper, and CPVC
- Tightens by hand - No tools required
- Eliminates soldering
- Secure fit prevents forward and backward movement

Model#	Size	For Pipe Size(s)	Box Qty
701	2" x 1-3/4"	1/2" CTS	50

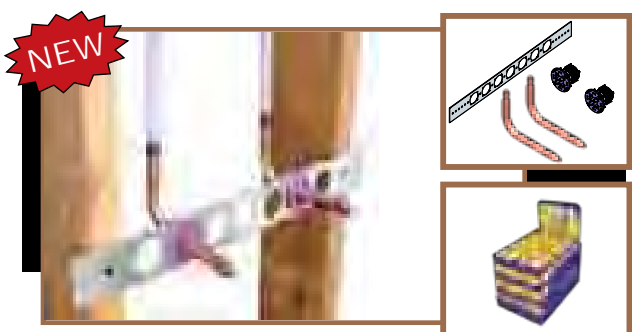

PEXRITE – #701-PR KIT

- PEX stub-out kit for lavatory/sink or toilet
- Includes (1) #103-18 galvanized bracket, (2) #701 stub-out clamps, and (2) 1/2" CTS 3.5" x 8" Copper Ells
- Installation photos on packaging. Great for Counter Sales.
- Available in Contractor kit, 6PAK, and Wholesaler point-of-purchase display
- Confirm compatibility of Copper Ells with PEX tubing manufacturer

Model#	For Pipe Size(s)	Kit Qty	6PAK Qty	Case Qty
701-PR	1/2" CTS	1	6	36

NEW

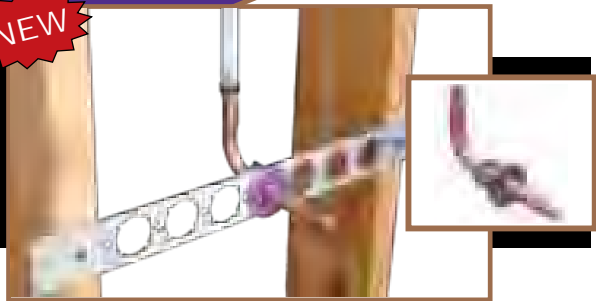

PEXRITE – #701-0536P, #701-0538P

- Stub-out clamp and Copper Ell in bulk packaging
- #701-0536P includes 1/2" CTS #701 stub-out clamp and 1/2" CTS 3.5" x 6" Copper Ell
- #701-0538P includes 1/2" CTS #701 stub-out clamp and 1/2" CTS 3.5" x 8" Copper Ell

Model#	Copper Ell Size	For Pipe Size(s)	Box Qty
701-0536P	1/2" CTS 3.5" x 6"	1/2" CTS PEX tubing	25 Clamps/ 25 Copper Ells
701-0538P	1/2" CTS 3.5" x 8"	1/2" CTS PEX tubing	25 Clamps/ 25 Copper Ells

NEW

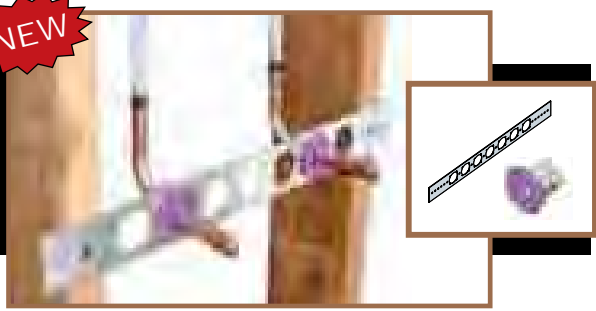

HOLDRITE – #103-18-701, #103-26-701

- Ideal for lavatory/sink and toilet
- Sold in bulk packaging
- #103-18-701 includes 20" brackets and 1/2" CTS #701 stub-out clamps
- #103-26-701 includes 26" brackets and 1/2" CTS #701 stub-out clamps

Model#	Size	For Pipe Size(s)	Box Qty
103-18-701	20" Bracket	1/2" CTS	50 Brackets/100 Clamps
103-26-701	26" Bracket	1/2" CTS	50 Brackets/100 Clamps

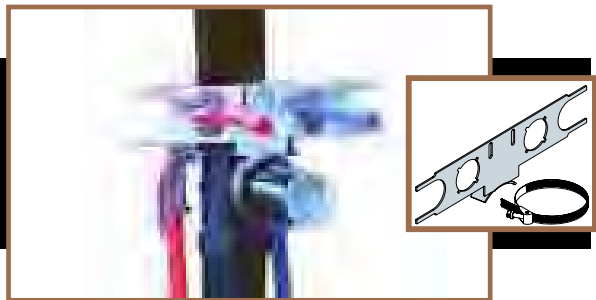

HOLDRITE – #110-R

- Ideal for lavatory/island sink
- Galvanized steel bracket with "key design" allows integration with various HOLDRITE inserts, #701, and #704
- Allows for easy Pre-fabrication at the shop or in the field
- Install directly to the waste/vent pipe prior to studs being erected
- Supports 4" and 8" centers
- Self-locking stainless steel band & isolating felt included

Model#	Bracket Size	For Pipe Size(s)	Box Qty
110-R	2-1/8" X 1-7/8"	1/2", 3/4", 1" CTS	50

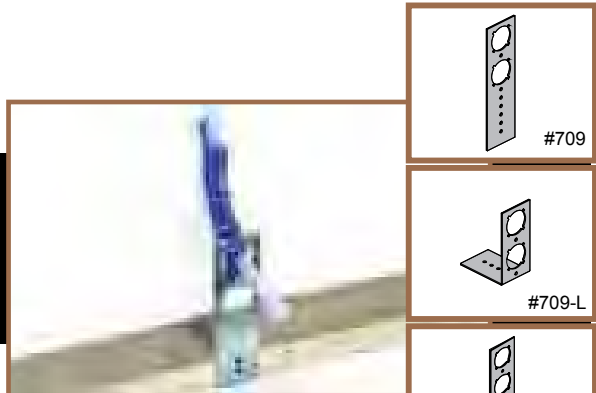

HOLDRITE – #709, #709-L, #709-EXT

- Ideal for water closets and hose bibs
- Galvanized steel brackets with 1-3/8" keyed holes
- Allows for 360-degree orientation when used with #701/#704
- #709 provides 4-1/4" and 6-1/4" center line heights
- #709-L provides 1-3/8" and 3-3/8" center line off stud/plate (3" & 5" off floor)
- #709-EXT provides 2", 4", 6", and 8" center line off plate or floor

Model#	Bracket Size	For Pipe Size(s)	Box Qty
709	7-1/2" X 2"	3/8" - 1" CTS	50
709-L	4-1/4" X 3-1/4" X 2"	3/8" - 1" CTS	50
709-EXT	9" X 2-1/8" X 2"	3/8" - 1" CTS	50



HOLDRITE – #721

- Attaches to framing or directly to HOLDRITE Stout Bracket®
- Ideal for lavatory or water closet support
- Galvanized steel bracket with 1-3/8" keyed hole
- Allows for 360-degree orientation when used with #701/#704

Model#	Bracket Size	For Pipe Size(s)	Box Qty
721	2-3/4" X 3-3/8"	3/8" - 1" CTS	50

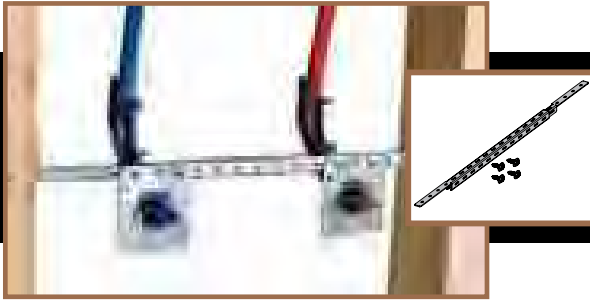

HOLDRITE STOUT BRACKET® – #SB1S, #SB2S

- Multi-purpose galvanized bracket supports various application solutions
- Ideal for lavatory, shower, water closet, vertical, horizontal and much more
- Telescoping design supports PEX, Copper, CPVC, and other types of piping
- Numerous components integrate into multiple sides of the Stout Bracket
- Provides superior strength and versatility
- Includes four screws

Model#	Bracket Size	For Pipe Size(s)	Box Qty
SB1S	10" to 18"	Various	50
SB2S	13" to 25"	Various	50



HOLDRITE – #101-18-R, #101-26-R

- Ideal for lavatory, water closet, and tub spout support
- Extruded holes provide additional soldering surface
- Ideal for PEX-to-Copper bullets
- Copper-bonded steel bracket
- #101-18-R provides 5/8" holes on 2" centers
- #101-26-R provides 5/8" holes on 2" centers and two 7/8" holes on 8" centers

Model#	Bracket Size	For Pipe Size(s)	Box Qty
101-18-R	20"	1/2" CTS	25
101-26-R	26"	1/2" CTS	25

NEW



PEXRITE – #705

- Turn-out support for 3/8" and 1/2" CTS PEX tubing
- Ideal for lavatory/sink & toilet stub-out and overhead 90° turn
- Mount to block of wood or other flat surface
- Unique design allows for side-entry of tubing

Model#	Size	For Pipe Size(s)	Box Qty
705	5-1/3" x 4-1/8" x 2-1/2"	3/8" & 1/2" CTS	50

NEW

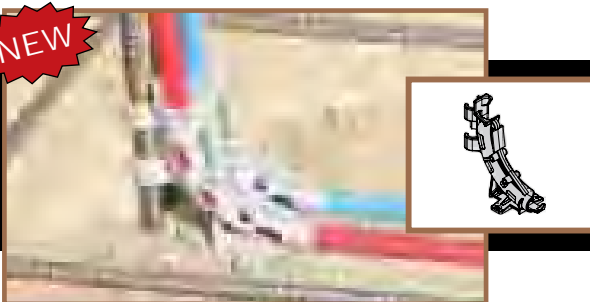

PEXRITE POP-UP™ – #706

- Single run PEXRITE POP-UP for RADIANT HEATING or other in-slab PEX tubing support (1-1/2" - 3-1/2" thick slab)
- Unique design allows for side-entry of tubing
- Mounts to form decking or slab-on-grade with rebar
- Manifold capability with interlocking feet

Model#	Size	For Pipe Size(s)	Box Qty
706	5-1/3" x 5" x 2-1/2"	3/8" & 1/2" CTS	50



PEXRITE POP-UP™ – #707, #707-E

- Single run PEXRITE POP-UP for in-slab flexible tubing support
- Manifold capability with interlocking feet
- Compatible with PEX, soft Copper, flexible conduit
- #707 design allows for side-entry of tubing
- #707-E design allows for easy zip tie installation
- Mounts to form decking or slab-on-grade with rebar

Model#	Size	For Pipe Size(s)	Box Qty
707	8-1/2" X 8-5/8" X 1-1/4"	3/8" thru 7/8" O.D.	25
707-E	8-1/2" X 8-5/8" X 1-1/4"	3/8" thru 1-1/2" O.D.	25

NEW

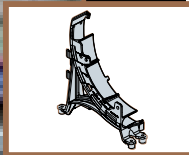

PEXRITE POP-UP™ – #708

- Double run PEXRITE POP-UP for in-slab flexible tubing support
- Manifold capability with interlocking feet
- Compatible with PEX, soft Copper, flexible conduit
- Unique design allows for side-entry of tubing
- Mounts to form decking or slab-on-grade with rebar

Model#	Size	For Pipe Size(s)	Box Qty
708	10-1/2" X 11-1/8" X 2-1/2"	3/8" thru 1-1/8" O.D.	15

NEW



PEXRITE POP-UP™ – #708-E

- Double run PEXRITE POP-UP for in-slab PEX tubing, flexible conduit, & rigid conduit 90s.
- Unique design allows for easy zip tie installation
- Mounts to form decking or slab-on-grade with rebar
- Manifold capability with interlocking feet

Model#	Size	For Pipe Size(s)	Box Qty
708-E	10-1/2" x 11-1/6" x 3-1/4"	3/8" thru 2-1/2" IPS	15

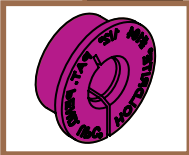
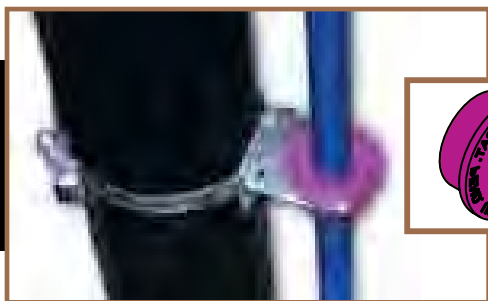

HOLDRITE INSERTS – #104 - #106

- Ideal for pipe support with HOLDRITE #121 & #103 series brackets
- Compatible with PEX, Copper, and CPVC tubing

Model#	Hole Needed	For Pipe Size(s)	Box Qty
104	1-3/8" Diameter	1/2" CTS	100
105	1-3/8" Diameter	3/4" CTS	100
106	1-3/8" Diameter	1" CTS	100

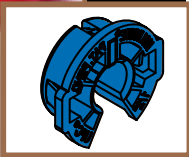

HOLDRITE INSERTS – #404-R - #406-R

- Ideal for metal studs with PEX, Copper, and CPVC tubing
- Integrates with most HOLDRITE galvanized brackets
- Flame-rated per UL 94 V-2 standards
- Fits in 1-3/8" or 1-11/32" holes

Model#	Hole Needed	For Pipe Size(s)	Box Qty
404-R	1-3/8" Diameter	1/2" CTS	100
405-R	1-3/8" Diameter	3/4" CTS	100
406-R	1-3/8" Diameter	1" CTS	100

NEW

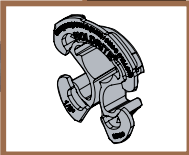

HOLDRITE ISOLATORS – #424 - #426

- Ideal for metal thru-stud applications and integrates with HOLDRITE #121 and #125 series brackets
- Positioning and dissimilar metal isolation for Copper, CPVC, and PEX tubing
- Meets UL 94 HB requirements

Model#	Hole Size	Pipe Size	Bag Qty	Master Carton Qty
424	1-11/32" & 1-3/8"	1/2" CTS	50	250
425	1-11/32" & 1-3/8"	3/4" CTS	50	250
426	1-11/32" & 1-3/8"	1" CTS	50	250