

# PRESSURE ACTUATED SHOWER VALVES

## PAM<sup>®</sup> II-ST 1/2" inlets and outlet

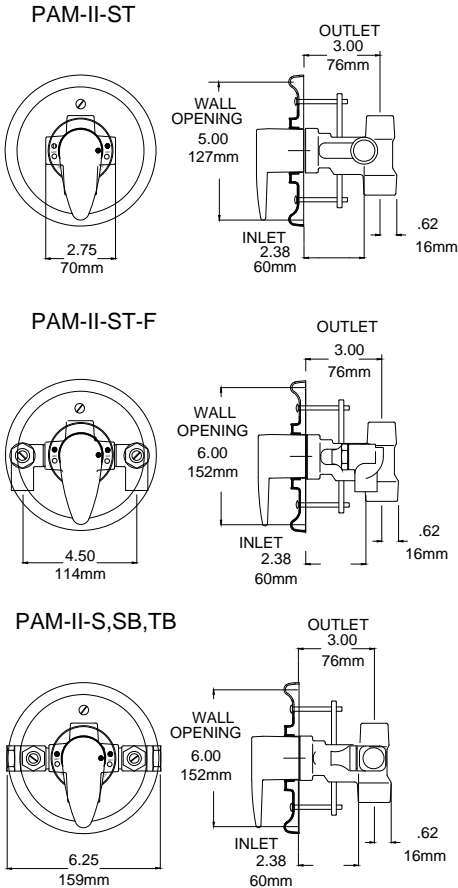

### SHOWER OR TUB/SHOWER



**PAM<sup>®</sup> II-ST Pressure Actuated mixer**

- Durable stainless steel balancing piston to equalize hot and cold supply pressures.
- Built-in shutoff for single handle operation
- Removable one piece upper and lower valve seat
- Internal parts of bronze and stainless steel
- Cast wall flange and lever handle, polished chrome plated
- Maximum operating pressure: 125 PSIG (860KPA)
- Adjustable high temperature limit stop set for 110°F\* (43°C)
- Color coded dial, Off through Hot, with directional indicators

Valve is ASSE · 1016 Certified  
 Valve is CSA · B.125-05 Certified



- \_\_ PAM<sup>®</sup> II-ST-S- Straight stops, IPS connection
- \_\_ PAM<sup>®</sup> II-ST-TB- Straight checkstops, IPS connection
- \_\_ PAM<sup>®</sup> II-ST-SB - Straight checkstops, copper tube connection
- \_\_ PAM<sup>®</sup> II-ST-F- Angle checkstops, copper tube connection

**OPTIONS:**

- \_\_ Suffix VP – Vandal resistant screws

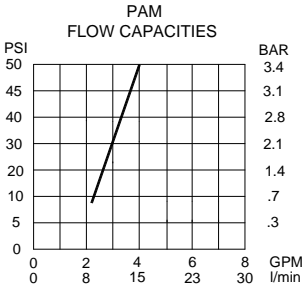

Job # _____	Engineer's Approval
Arch/Eng. _____	
Contractor _____	

**\*NOTE:** A limit stop, set for 110°F (43°C), is simply a mechanical setting to prevent excessive handle rotation. If incoming water is hotter than 135°F (57°C), the temperature of the factory test, the valve when turned to full HOT may deliver water in excess of 110°F and the limit stop MUST BE RESET BY THE INSTALLER



1360 Elmwood Avenue, Cranston, RI 02910 USA  
 Phone: 401.461.1200 Fax: 401.941.5310  
 Email: [info@leonardvalve.com](mailto:info@leonardvalve.com)  
 Web Site: <http://www.leonardvalve.com>

# ACCESSORIES

# HAND SHOWERS

### 500P

- Hand spray
- 69" (1753mm) braided stainless steel flex hose
- 2 wall hooks
- Double check valve backflow preventer
- Supply elbow and flange
- 2.5 GPM (9.5 l/min.) max. flow rate

### 501P(G)

- Hand spray
- 69" (1753mm) braided stainless steel flex hose
- 24" (610mm) glide rail
- Double check valve backflow preventer
- Supply elbow and flange
- 2.5 GPM (9.5 l/min.) max. flow rate

### 501P(G)-30

- As above with 30" (762mm) glide rail

### 501P

- Hand spray
- 69" (1753mm) braided stainless steel flex hose
- 24" (610mm) slide bar
- Double check valve backflow preventer
- Supply elbow and flange
- 2.5GPM (9.5 l/min.) max. flow rate

### 503P

- Same as 501P but with 48"(1219mm) slide bar

### OPTIONS:

- SUFFIX ADJ – Deluxe adjustable spray
- SUFFIX RV - Reinforced vinyl hose
- SUFFIX QD - Quick connector set
- SUFFIX 476 - Volume control



Hand showers must be able to be mounted between 38" and 48" above the finished floor. For ADA compliance, consult Americans with Disabilities Act or local regulations for model choices and locations.

### 500P

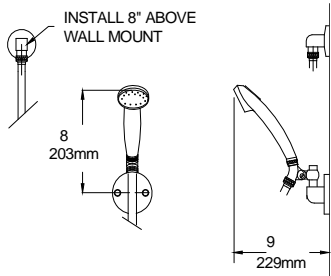

### 501P(G)

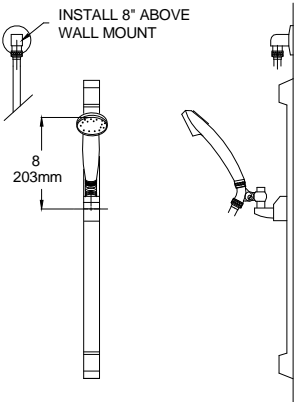

### 501P

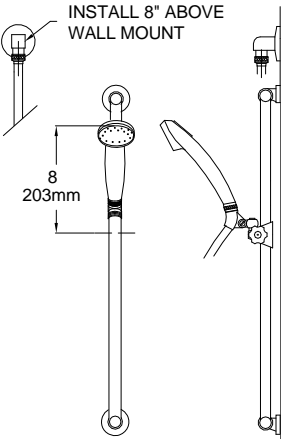

1360 Elmwood Avenue, Cranston, RI 02910 USA  
Phone: 401.461.1200 Fax: 401.941.5310  
Email: [info@leonardvalve.com](mailto:info@leonardvalve.com)  
WEB: <http://www.leonardvalve.com>

# ACCESSORIES

# VACUUM BREAKERS

## EVB

- Elevated vacuum Breaker unit
- Chrome plated
- 1/2" IPS inlet

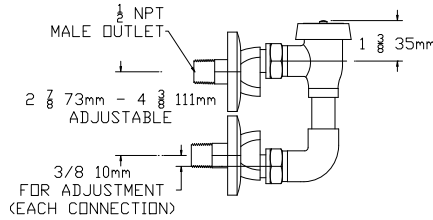

## LVB

- Vacuum Breaker unit
- Chrome plated
- 1/2" IPS inlet
- 1/2" hose connection outlet

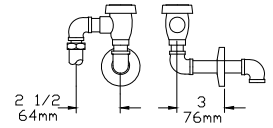

# INSTITUTIONAL HOSE SPRAYS

## 5P

- 6 ft. (1828mm) of 3/8" rubber hose
- Plain end
- Wall hook

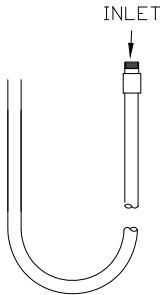

## 5RS

- 6 ft. (1828mm) of 3/8" rubber hose
- 3" (76mm) rose spray
- Wall hook

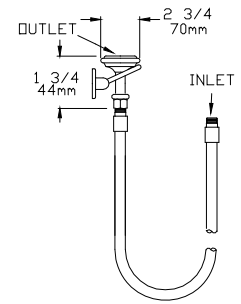

# INLINE VACUUM BREAKERS

## 5SCRS

- 6 ft. (1828mm) of 3/8" rubber hose
- Self closing rose spray
- Wall hook

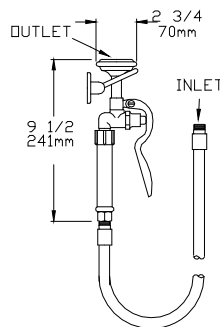

## INVB

- Inline vacuum breaker
- 1/2" IPS inlet
- 1/2" hose connection outlet

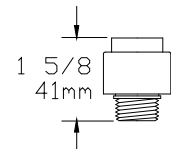

# FLUSH MOUNTED DIAL THERMOMETER

## 37C50FL

- 1 15/16" (49mm) bulb rubber hose
- 25 to 125°F, 0 to 50°C
- 3" (76mm) white dial, black printing
- Wall flange, mounting bracket, screws and gasket

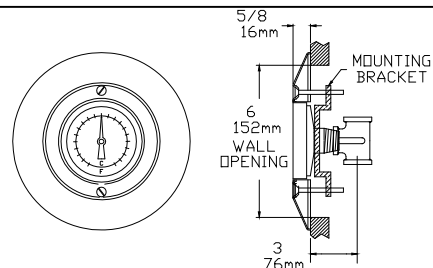

1360 Elmwood Avenue, Cranston, RI 02910 USA

Phone: 401.461.1200 Fax: 401.941.5310

Email: [info@leonardvalve.com](mailto:info@leonardvalve.com)

WEB: <http://www.leonardvalve.com>