

Class 125 Bronze Gate Valves

Screw-in Bonnet • Non-Rising Stem • Solid Wedge

125 PSI/8.6 Bar Saturated Steam to 353° F/178° C
200 PSI/13.8 Bar Non-Shock Cold Working Pressure

CONFORMS TO MSS SP-80

MATERIAL LIST

| PART | SPECIFICATION |
|-------------------------|---|
| 1. Handwheel Nut | 300 Series Stainless Steel |
| 2. Identification Plate | Aluminum |
| 3. Handwheel | a. Malleable Iron ASTM A 47 (T-113) b. Bronze (T-113-BHW) c. Bronze Cross (T-113-K) |
| 4. Stem | Silicon Bronze ASTM B 371 Alloy C69400/C69430 or ASTM B99 Alloy C65100 |
| 5. Packing Nut | Bronze ASTM B 62 or ASTM B 584 Alloy C84400 or Brass ASTM B 16 |
| 6. Packing Gland | Bronze ASTM B 62 or ASTM B 584 Alloy C84400 or Brass ASTM B 16 |
| 7. Packing | Aramid Fibers with Graphite |
| 8. Stuffing Box | Bronze ASTM B 62 |
| 9. Bonnet | Bronze ASTM B 62 |
| 10. Body | Bronze ASTM B 62 |
| 11. Wedge | Bronze ASTM B 62 |

DIMENSIONS—WEIGHTS—QUANTITIES

| Size | Dimensions | | | | | | T-113 | | S-113 | | Master Ctn. Qty. | |
|------|------------|------|-----|------|-----|------|-------|-------|-------|-------|------------------|------|
| | In. | mm. | In. | mm. | In. | mm. | In. | mm. | Lbs. | Kg. | | Lbs. |
| ¼ † | 8 | 1.69 | 43 | 3.38 | 86 | x | x | 0.74 | 0.33 | x | x | 50 |
| ⅜ † | 10 | 1.69 | 43 | 3.38 | 86 | .69 | 18 | 0.71 | 0.32 | 0.65 | 0.29 | 50 |
| ½ † | 15 | 1.94 | 49 | 3.63 | 92 | .75 | 19 | 0.82 | 0.37 | 0.67 | 0.31 | 50 |
| ¾ | 20 | 2.06 | 54 | 3.91 | 99 | .88 | 22 | 1.10 | 0.50 | 0.99 | 0.45 | 50 |
| 1 | 25 | 2.44 | 62 | 4.69 | 119 | 1.00 | 25 | 1.82 | 0.82 | 1.60 | 0.72 | 30 |
| 1¼ | 32 | 2.63 | 67 | 5.22 | 133 | 1.19 | 32 | 2.40 | 1.09 | 2.25 | 1.02 | 20 |
| 1½ | 40 | 2.88 | 72 | 6.25 | 159 | 1.25 | 33 | 3.51 | 1.59 | 3.17 | 1.44 | 10 |
| 2 | 50 | 3.06 | 78 | 7.06 | 179 | 1.31 | 34 | 4.93 | 2.24 | 4.60 | 2.09 | 10 |
| 2½ | 65 | 4.13 | 105 | 8.41 | 224 | 1.81 | 46 | 9.96 | 4.52 | 8.78 | 3.98 | 5 |
| 3 | 80 | 4.50 | 114 | 10 | 254 | 1.94 | 49 | 14.40 | 6.53 | 12.84 | 5.82 | 4 |

† No packing gland, packing only in these sizes.
x Not available this size.

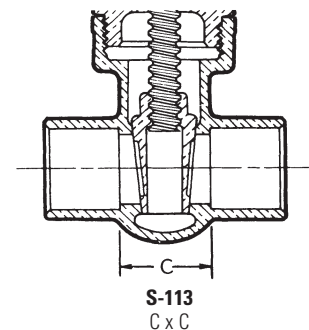
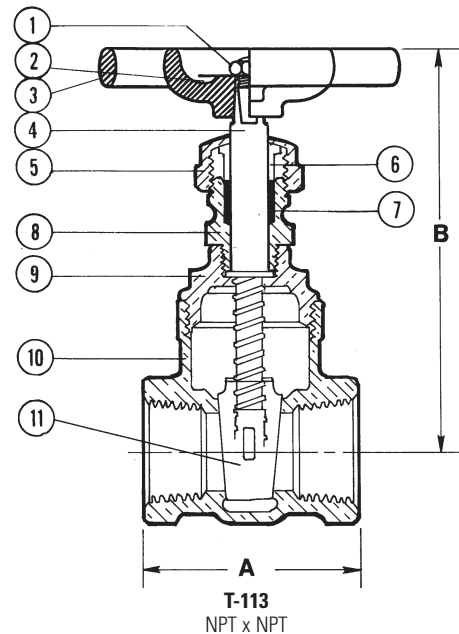

Freezing Weather Precaution – Subsequent to testing a piping system, valves should be in an open position to allow complete drainage.

◆ For detailed Operating Pressure, refer to Pressure Temperature Chart on page 111.