



82-100/82A-140 SERIES

3-Piece Full Port Threaded Bronze Ball Valve

Job Name:	Contractor:
Job Location:	P.O. Number:
Engineer:	Representative:
Tag:	Wholesale Distributor:

DESCRIPTION

The Apollo® 82-100 Series is designed as an in-line repairable Bronze Ball Valve. SAE Grade Body Bolts are Standard.

FEATURES

- Adjustable Packing Gland
- Blow-Out Proof Stem Design
- RPTFE Seats and Seals
- Full Port Ball Configuration

PERFORMANCE RATING

- Maximum Pressure:
82A140: 400 psi CWP, 150 psi SWP
82100 & 82140: 600 psi CWP, 150 psi SWP
- Maximum Temperature: 500°F
- Vacuum Service to 29 in. Hg

MODELS

- | | |
|---|-------------------------------------|
| <input type="checkbox"/> 82-100 Series | Standard |
| <input type="checkbox"/> 82-140 Series | 316 SS Ball & Stem |
| <input type="checkbox"/> 82-150 Series | Balancing Stop |
| <input type="checkbox"/> 82A-140 Series | 3" & 4" Only (No Options Available) |



DIMENSIONS

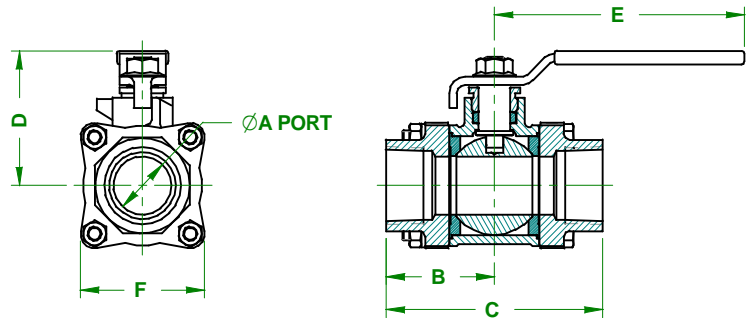

STANDARD MATERIALS LIST

Part Name	Material
Lever and Grip	Steel, Zinc Plated w/ Vinyl
Stem Packing	RPTFE
Stem Bearing	RPTFE
Ball	ASTM B16 (Brass), Chrome Plated (1/4" - 2") ASTM 276-316 SS (3" - 4")
Seat (2)	RPTFE
End Cap (2)	B16 (1/4" to 3/8"), B584-C84400 (1/2" - 4")
Gland Nut	ASTM B16 (Brass)
Stem	ASTM B16 (Brass), Chrome Plated (1/4" - 2") ASTM 276-316 SS (3" - 4")
Lever Nut	Steel, Zinc Plated
Body Bolt	Steel, Zinc Plated
Hex Nut	Steel, Zinc Plated
Body	ASTM B584-C84400 (Bronze)

APPROVALS

- MSS SP-10; Ball Valves, Threaded, Socket-Welding, Solder Joint, Grooved and Flared Ends
- CRN: OC10908.5C

PART #	Size (in.)	Dimensions						Wt. (Lbs.)
		A	B	C	D	E	F	
82-101	1/4"	0.43	1.28	2.56	1.81	3.87	1.60	1.02
82-102	3/8"	0.50	1.28	2.56	1.81	3.87	1.60	1.04
82-103	1/2"	0.62	1.40	2.81	1.93	4.87	1.78	1.55
82-104	3/4"	0.81	1.71	3.43	2.18	4.87	1.98	2.27
82-105	1"	1.00	1.93	3.87	2.62	5.50	2.22	3.28
82-106	1 1/4"	1.25	2.37	4.75	2.87	5.50	2.70	5.62
82-107	1 1/2"	1.50	2.62	5.25	3.37	8.00	3.03	8.07
82-108	2"	2.00	3.01	6.03	3.68	8.00	3.87	14.42
82-109	2 1/2"	2.50	3.62	7.25	5.14	9.75	5.05	26.61
82-140	3"	3.00	4.00	8.00	6.77	18.00	7.69	42.24
82A-140	3"	3.00	4.18	8.37	8.10	19.13	5.82	43.00
82-14A	4"	4.00	5.50	11.00	8.26	18.00	10.25	88.40
82A-14A	4"	4.00	5.43	10.86	8.88	19.13	7.77	106.00

Conbraco Industries, Inc. 701 Matthews Mint Hill Rd. Matthews NC 28106 USA; www.apollovalves.com ; 704-841-6000

This specification is provided for reference only. Conbraco reserves the right to change any portion of this specification without notice and without incurring obligation to make such changes to Conbraco products previously or subsequently sold.



82-100/82A-140 SERIES

3-Piece Full Port Threaded Bronze Ball Valve

OPTIONS & SIZES

<input type="checkbox"/> (-02) Stem Grounded	1/4" - 4"
<input type="checkbox"/> (-03) 1 1/4" CS Stem Extension	1/4" - 2"
<input type="checkbox"/> (-04) 2 1/4" CS Stem Extension	1/4" - 2"
<input type="checkbox"/> (-05) Plain Ball	1/4" - 4"
<input type="checkbox"/> (-07) Steel Tee Handle	1/4" - 2"
<input type="checkbox"/> (-08) 90° Reversed Stem	1/4" - 4"
<input type="checkbox"/> (-10) SS Lever & Nut	1/4" - 4"
<input type="checkbox"/> (-14) Side Vented Ball (Uni-Directional)	1/4" - 4"
<input type="checkbox"/> (-15) Wheel Handle, Steel	1/4" - 2"
<input type="checkbox"/> (-16) Chain Lever-Vertical	1/2" - 2"
<input type="checkbox"/> (-18) Plain Yellow Grip	1/4" - 2"
<input type="checkbox"/> (-19) Lock Plate	1/4" - 4"
<input type="checkbox"/> (-20) Slot Vented Ball	1/4" - 4"
<input type="checkbox"/> (-21) UHMWPE Trim (Non-PTFE)	1/4" - 4"
<input type="checkbox"/> (-23) Tank Flange	2" Only
<input type="checkbox"/> (-24) Graphite Packing	1/4" - 4"
<input type="checkbox"/> (-27) SS Latch-Lock Lever & Nut	1/2" - 2"
<input type="checkbox"/> (-30) Cam-Lock & Grounded	1/4" - 1 1/4"
<input type="checkbox"/> (-32) SS Tee Handle & Nut	1/4" - 2"
<input type="checkbox"/> (-35) PTFE Trim	1/4" - 4"
<input type="checkbox"/> (-39) SS Hi-Rise Locking Wheel Handle & Nut	1/4" - 1 1/4"
<input type="checkbox"/> (-40) Cyl-Loc & Grounded	1/4" - 1/2"
<input type="checkbox"/> (-45) Less Lever & Nut	1/4" - 4"
<input type="checkbox"/> (-46) Latch Lock Lever-Lock Closed Position Only	1/2" - 2"
<input type="checkbox"/> (-47) SS Oval Latch-Lock Handle & Nut	1/4" - 3/4"
<input type="checkbox"/> (-48) SS Oval Handle (No Latch) & Nut	1/4" - 2"
<input type="checkbox"/> (-49) Assembled Dry	1/4" - 4"
<input type="checkbox"/> (-50) 2-1/4" CS Locking Stem Extension	1/4" - 2"
<input type="checkbox"/> (-56) MPTFE Seats and Packing	1/4" - 4"
<input type="checkbox"/> (-57) Oxygen Cleaned	1/4" - 4"
<input type="checkbox"/> (-58) Chain Lever-Horizontal	3/4" - 2"
<input type="checkbox"/> (-59) SS External Trim	3/4" - 4"
<input type="checkbox"/> (-60) Static Grounded Ball & Stem	1/4" - 4"
<input type="checkbox"/> (-63) NPT x Solder	3/8" - 4"
<input type="checkbox"/> (-P01) BSPP (Parallel) Thread Connection	1/4" - 4"
<input type="checkbox"/> (-T01) BSPT (Tapered) Thread Connection	1/4" - 4"

Conbraco Industries, Inc. 701 Matthews Mint Hill Rd. Matthews NC 28106 USA; www.apollovalves.com ; 704-841-6000

Conbraco Industries can accept no responsibility for possible errors in this document and reserves the right to alter its product design or construction without notice and without incurring any obligation to make such changes on Conbraco products previously or subsequently sold.

All product specifications are approximate and are provided for reference only.